

PRODUCT CATALOG

VOLUME V, 2024



ARABI SLING & RIGGING

EXPERIENCE YOU CAN TRUST

Manufactured in the USA since 1972

A LEADING MANUFACTURER OF: Polyester Roundslings / High Performance Roundslings
Nylon & Polyester Web Slings / Tie-Downs / Recovery Straps / Flow Line Restraints / Cargo Nets

ALSO OFFERING: Wire Rope / Wire Rope Slings / Chain / Chain Slings / Hardware / Rope

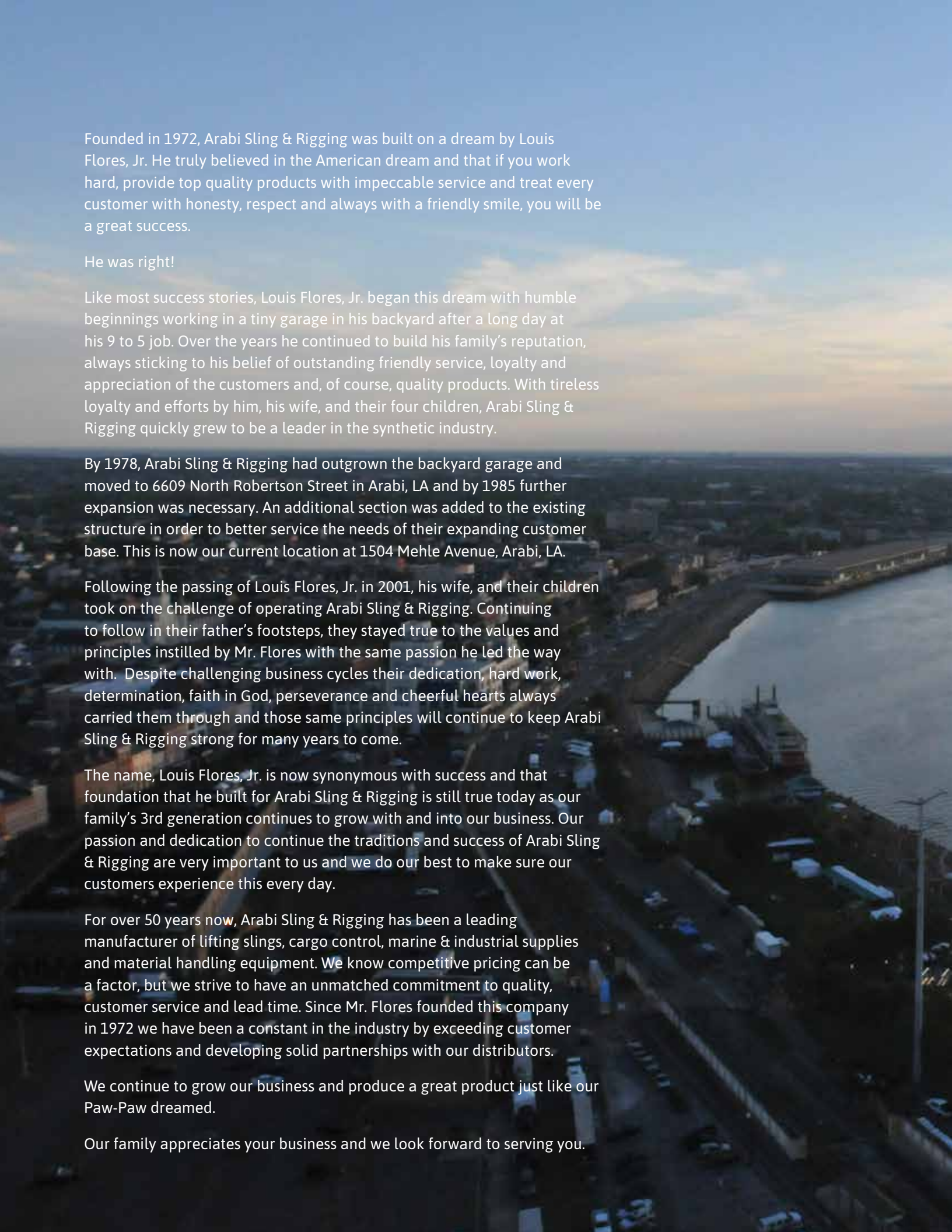

Founded in 1972, Arabi Sling & Rigging was built on a dream by Louis Flores, Jr. He truly believed in the American dream and that if you work hard, provide top quality products with impeccable service and treat every customer with honesty, respect and always with a friendly smile, you will be a great success.

He was right!

Like most success stories, Louis Flores, Jr. began this dream with humble beginnings working in a tiny garage in his backyard after a long day at his 9 to 5 job. Over the years he continued to build his family's reputation, always sticking to his belief of outstanding friendly service, loyalty and appreciation of the customers and, of course, quality products. With tireless loyalty and efforts by him, his wife, and their four children, Arabi Sling & Rigging quickly grew to be a leader in the synthetic industry.

By 1978, Arabi Sling & Rigging had outgrown the backyard garage and moved to 6609 North Robertson Street in Arabi, LA and by 1985 further expansion was necessary. An additional section was added to the existing structure in order to better service the needs of their expanding customer base. This is now our current location at 1504 Mehle Avenue, Arabi, LA.

Following the passing of Louis Flores, Jr. in 2001, his wife, and their children took on the challenge of operating Arabi Sling & Rigging. Continuing to follow in their father's footsteps, they stayed true to the values and principles instilled by Mr. Flores with the same passion he led the way with. Despite challenging business cycles their dedication, hard work, determination, faith in God, perseverance and cheerful hearts always carried them through and those same principles will continue to keep Arabi Sling & Rigging strong for many years to come.

The name, Louis Flores, Jr. is now synonymous with success and that foundation that he built for Arabi Sling & Rigging is still true today as our family's 3rd generation continues to grow with and into our business. Our passion and dedication to continue the traditions and success of Arabi Sling & Rigging are very important to us and we do our best to make sure our customers experience this every day.

For over 50 years now, Arabi Sling & Rigging has been a leading manufacturer of lifting slings, cargo control, marine & industrial supplies and material handling equipment. We know competitive pricing can be a factor, but we strive to have an unmatched commitment to quality, customer service and lead time. Since Mr. Flores founded this company in 1972 we have been a constant in the industry by exceeding customer expectations and developing solid partnerships with our distributors.

We continue to grow our business and produce a great product just like our Paw-Paw dreamed.

Our family appreciates your business and we look forward to serving you.

TABLE OF CONTENTS

2

ROUNDSLINGS

Big Easy Roundslings
Big Easy High Performance Roundslings
Big Easy Heavy Cover Roundslings
Big Easy Eye & Eye Roundslings
Big Easy Stage Roundslings
Big Easy Bridle Roundslings

10

POLYESTER FLOW LINE RESTRAINTS

Big Easy Flow Line Restraint

11

WEB SLINGS

Types of Webbing
How to Order Web Slings
Triangle/Triangle and Triangle/Choker Web Slings
Flat & Twisted Eye/Eye Web Slings
Endless Web Slings
Reverse Eye & Flat Eye Web Slings
Bridle Web Slings
Wide Body Basket Slings
Load Balancer Basket Slings
Stone Handling Slings
Hose Handling Slings

22

RECOVERY STRAPS

Web Recovery Straps
Big Easy Recovery Eye/Eye Straps

23

PROTECTION

Wear Protection Features & Benefits
Cut Protection
Protection: Hook & Loop Flat & Tubular Sleeves

26

CARGO CONTROL

Web Load Hugger - Assemblies (WLH)
Tie Down Straps & End Fittings
Web Cargo Net
End Fitting Options Available

29

TAG OPTIONS

30

MARINE BOAT SLINGS

32

LADDERS

35

RIGGING & HARDWARE

ROUNDSLING INFORMATION

Common Types of Sling Hitches

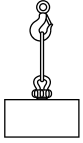
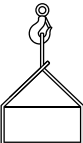
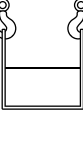
Hitch	Comments
 <p>Vertical Hitch</p>	One end is placed on the hook, while the other end is attached directly to the load. A tagline should be used to prevent load rotation.
 <p>Choker Hitch</p>	Sling passes through one end around the load and the other end is placed on the hook. Rated capacity is normally 80% of that for a vertical hitch. Load control is a potential problem with only one sling rigged in a choker hitch. Also, the choke point should always be on the sling body—not on the fittings, base of the fitting or tag.
 <p>Basket Hitch</p>	The sling cradles the load while both ends are attached overhead. The rated capacity for a basket hitch is twice that for a vertical hitch. As with the choker hitch, more than one sling rigged in a basket hitch (or some other means) may be necessary to help ensure load control.

Increased sling tension as a function of sling-to-load angle

Angle "A" in degrees from horizontal	Tension Multiplier
90	1.000
85	1.004
80	1.015
75	1.035
70	1.064
65	1.104
60	1.155
55	1.221
50	1.305
45	1.414
40	1.555
35	1.742
30	2.000

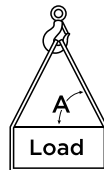

Multiply the load weight (per leg) by the tension factor to determine the increased tension of the sling leg(s)

Reductions in rated capacity as a function of angle of choke

Angle of Choke (degrees)	Angle of Choke Reduction Factor	
	= or >	<
120	180	1.000
105	120	0.82
90	105	0.71
60	90	0.58
0	60	0.50

Actual Sling Capacity = Rated Capacity x Reduction Factor

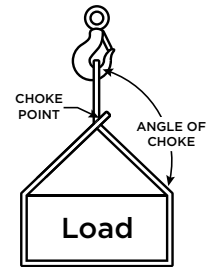

The radii values apply to roundslings that are fully tensioned to their rated capacity regardless of the hitch.

When roundslings are tensioned to lower force values, the minimum radius values will reduce accordingly.

Fractional inches are rounded up to the nearest 1/16" (1.58 mm).

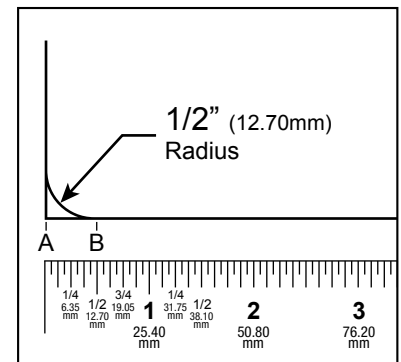

Minimum edge radii suitable for contact unprotected polyester roundslings

Sling Size	Vertical Rated Capacity		Minimum Edge Radii		Minimum Edge Radii		Sling Width at Load	
	lbs.	kgs.	inch	mm	inch	mm	inch	mm
1	2,600	1,200	0.14	3.55	3/16	4.76	0.97	24.63
2	5,300	2,400	0.21	5.33	1/4	6.35	1.29	32.76
3	8,400	3,800	0.26	6.60	5/16	7.93	1.66	42.16
4	10,600	4,800	0.30	7.62	5/16	7.93	1.78	45.21
5	13,200	6,000	0.33	8.38	3/8	9.52	2.00	50.80
6	16,800	7,600	0.40	10.16	7/16	11.11	2.13	54.10
7	21,200	9,600	0.41	10.41	7/16	11.11	2.62	66.54
8	25,000	11,400	0.44	11.17	7/16	11.11	2.85	72.39
9	31,000	14,100	0.50	12.70	1/2	12.70	3.15	80.01
10	40,000	18,200	0.56	14.22	9/16	14.28	3.57	90.67
11	53,000	24,100	0.67	17.01	11/16	17.46	4.00	101.60
12	66,000	30,000	0.72	18.28	3/4	19.05	4.60	116.84
13	90,000	40,900	0.87	22.09	7/8	22.22	5.22	132.58

Suitable connection hardware sizes for Polyester Roundslings when used in Choker and Vertical hitches

Sling Size	Roundslings		Minimum Hardware Size							
	Rated Cap.	Vert. Hitch	Stock Dia. or Thickness				Effective Contact Width			
			lbs.	kgs.	in	mm	in	mm	in	mm
1	2,600	1,200	.39	9.90	7/16	11.11	.97	24.63	1	25.40
2	5,300	2,400	.59	14.98	5/8	15.87	1.29	32.76	1-3/8	34.92
3	8,400	3,800	.72	18.28	3/4	19.05	1.66	42.16	1-3/4	44.45
4	10,600	4,800	.85	21.59	7/8	22.22	1.78	45.21	1-7/8	47.62
5	13,200	6,000	.95	24.13	1	25.40	2.00	50.80	2	50.80
6	16,800	7,600	1.12	28.44	1-1/8	28.57	2.13	54.10	2-1/8	53.97
7	21,200	9,600	1.15	29.21	1-3/16	30.16	2.62	66.54	2-5/8	66.67
8	25,000	11,400	1.25	31.75	1-1/4	31.75	2.85	72.39	2-7/8	73.02
9	31,000	14,100	1.41	35.81	1-1/2	38.10	3.15	80.01	3-1/4	82.55
10	40,000	18,200	1.60	40.64	1-5/8	41.27	3.57	90.67	3-5/8	92.07
11	53,000	24,100	1.90	48.26	2	50.80	4.00	101.60	4	101.60
12	66,000	30,000	2.05	52.07	2-1/8	53.97	4.60	116.84	4-5/8	117.47
13	90,000	40,900	2.46	62.48	2-1/2	63.50	5.22	132.58	5-1/4	133.35

Roundslings Removal from Service Criteria

- If Roundslings identification tag is missing or not readable
- Holes, tears, cuts, embedded materials, excessive abrasive wear, or snags that expose the core yarn of the Roundslings.
- Broken or damaged core yarn.
- If Roundslings has been tied into one or more knots.
- Acid or caustic burns of the Roundslings.
- Melting, charring or weld spatter of any part of the Roundslings.
- Distortion, excessive pitting, corrosion or other damage to fitting(s).
- Broken or worn stitching in the cover which exposes the core yarn.
- Any conditions which cause doubt as to the strength of the Roundslings.



WHERE TO FIND ADDITIONAL INFORMATION:

- WSTDA-RS-1 – RECOMMENDED STANDARD SPECIFICATION FOR SYNTHETIC POLYESTER ROUNDSLINGS
- WSTDA-RS-1HP – RECOMMENDED STANDARD SPECIFICATION FOR HIGH PERFORMANCE YARN ROUNDSLINGS
- WSTDA-RS-2 – RECOMMENDED OPERATING AND INSPECTION MANUAL FOR SYNTHETIC POLYESTER ROUNDSLINGS
- ASME B30.9 – SYNTHETIC ROUNDSLINGS: SELECTION, USE AND MAINTENANCE
- OSHA GUIDANCE ON SAFE SLING USE ([HTTP://WWW.OSHA.GOV/DSG/GUIDANCE/SLINGS/SYNTH-ROUND.HTML](http://www.osha.gov/dsg/guidance/sl原因ings/synth-round.html))
- OSHA 29 CFR 1910.184 SLINGS
- RIGGING HANDBOOKS
- FORMAL TRAINING FROM CERTIFIED THIRD PARTY OR MANUFACTURER



BIG EASY ROUNDSLING

A Roundsling is constructed using a continuous loop of core yarns encased in a double wall cover. This cover helps to protect the load bearing yarn from abrasion.

Features & Benefits:

- Vertical, Choker & Basket Hitch
- Vertical Capacities from 2,600 lbs. to 110,000 lbs.
- Load bearing points can be rotated to extend life
- Lightweight: Easy to use, versatile, high strength-to-weight ratio
- Low Stretch: Approximately 3% at rated capacity
- Color Coded by Capacity: Allows for quick identification
- Double Wall, Seamless Cover
 - » Helps protect core yarn from UV degradation
 - » Soft cover helps to prevent scratches to load surface



Overall Length

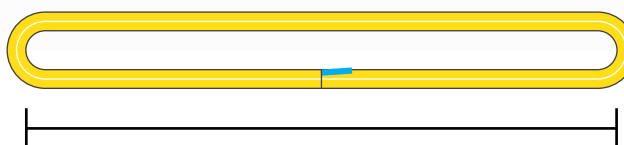

Manufacturing Tolerance:

+/-1"+ 2% of specified length

Part #	Color Code	RATED CAPACITY IN POUNDS				Minimum Length	Weight Per Foot (lbs.)	Body DIA Relaxed
		Vertical	Choker	Basket At 90°	Basket At 45°			
BRS30	PURPLE	2,600	2,100	5,200	3,600	2'	0.2	5/8"
BRS60	GREEN	5,300	4,240	10,600	7,400	2'	0.3	7/8"
BRS90	YELLOW	8,400	6,700	16,800	11,800	2'	0.5	1 1/8"
BRS120	TAN	10,600	8,500	21,200	14,000	2'	0.6	1 1/8"
BRS150	RED	13,200	10,600	26,400	18,000	3'	0.8	1 3/8"
BRS180	WHITE	16,800	13,400	33,600	23,000	3'	0.9	1 3/8"
BRS240	BLUE	21,200	17,000	42,400	29,000	3'	1.3	1 3/4"
BRS300	ORANGE	25,000	20,000	50,000	35,000	4'	1.5	2"
BRS360	GREY	31,000	24,800	62,000	43,300	4'	1.7	2 1/4"
BRS400	ORANGE	40,000	32,000	80,000	56,500	6'	2.2	2 1/2"
BRS600	BROWN	53,000	42,400	106,000	74,000	6'	2.8	2 3/4"
BRS800	OLIVE	66,000	52,800	132,000	93,000	6'	3.4	3 1/8"
BRS1000	BLACK	90,000	72,000	180,000	127,000	6'	4.3	3 5/8"
BRS1100	BLACK	100,000	80,000	200,000	141,000	6'	4.83	4 1/4"
BRS1200	BLACK	110,000	88,000	220,000	155,000	8'	5.28	4 1/2"

* Larger Capacities Available. Please contact our office for a quote and more information.



WARNING: Do not exceed rated capacities. Sling capacity decreases as the angle from horizontal decreases. Slings should never be used at angles less than 30 degrees.



BIG EASY HIGH PERFORMANCE ROUNDSLING



Overall Length



High Performance Roundslings are constructed using a continuous loop of UHMPE core yarns encased in a texturized nylon, double wall cover. This heavy duty cover helps to protect the load bearing core yarn from abrasion and increase the life of the sling.

Features & Benefits:

- Vertical, Choker & Basket Hitch
- Load bearing points can be rotated to extend life
- Lightweight: Ease of use compared to wire rope and chain
- Low Stretch: Approximately 1% at rated capacity
- Highest capacity for the lightest weight
- Texturized Nylon Double Wall, Seamless Cover
 - » Helps protect core yarn from UV degradation
 - » Soft cover helps to prevent scratches to load surface
- Two sliding wear sleeves standard on all BHP slings

Manufacturing Tolerance:

+/-1" + 2% of specified length

Size	RATED CAPACITY IN POUNDS				Min. Length	Body DIA Relaxed (in.)	Width at Load (in.)	Weight Per Foot (lbs.)	Min. Hardware Diameter (in.)	Min. Edge Radii (in.)
	Vertical	Choker	Basket At 90°	Basket At 45°						
BHP10	10,000	8,000	20,000	14,100	4'	1.00	1.60	0.45	0.69	.43
BHP20	20,000	16,000	40,000	28,000	4'	1.25	2.00	0.55	1.06	.63
BHP30	30,000	24,000	60,000	42,000	6'	1.40	2.13	0.70	1.44	.75
BHP40	40,000	32,000	80,000	56,000	6'	1.75	2.75	0.82	1.50	.88
BHP50	50,000	40,000	100,000	70,000	8'	1.90	2.88	1.02	1.75	.88
BHP60	60,000	48,000	120,000	84,000	8'	2.00	3.13	1.15	2.00	1.00
BHP70	70,000	56,000	140,000	98,000	8'	2.15	3.25	1.29	2.19	1.13
BHP80	80,000	64,000	160,000	113,000	8'	2.25	3.50	1.5	2.38	1.25
BHP90	90,000	72,000	180,000	127,000	10'	2.50	3.88	1.64	2.38	1.25
BHP100	100,000	80,000	200,000	141,000	10'	2.75	4.25	1.77	2.50	1.38
BHP125	125,000	100,000	250,000	176,000	10'	3.00	4.88	2.15	2.63	1.50
BHP150	150,000	120,000	300,000	210,000	10'	3.25	5.25	2.49	2.88	1.50
BHP175	175,000	140,000	350,000	240,000	10'	3.50	5.75	3.12	3.13	1.75
BHP200	200,000	160,000	400,000	280,000	10'	3.75	6.13	3.46	3.38	1.75

* Please contact our office for a quote and more information on larger sizes

** BHP10 is made using a Non Heavy Cover Jacket



WARNING: Do not exceed rated capacities. Sling capacity decreases as the angle from horizontal decreases. Slings should never be used at angles less than 30 degrees.



BIG EASY HEAVY COVER ROUNDSLING

Big Easy Heavy Cover Roundslings are made using a heavy duty, double wall nylon outer cover. This helps to increase the life of the sling by providing built-in abrasion resistance without the need for bulky wear pads or extra material.

Features & Benefits:

- Sling made with heavy duty double wall nylon cover
- Non-abrasive nylon cover reduces marring on painted and plated surfaces
- Soft, Pliable and Easy to handle
- Additional Sleeves Available

Manufacturing Tolerance:

+/- 1" + 2% of specified length



Overall Length



Part #	Color Code	RATED CAPACITY IN POUNDS				Minimum Length	Weight Per Foot (lbs.)	Body DIA Relaxed
		Vertical	Choker	Basket At 90°	Basket At 45°			
BHC150	ORANGE	13,200	10,600	26,400	18,000	3'	0.85	1 3/8"
BHC180	ORANGE	16,800	13,400	33,600	23,000	3'	0.98	1 3/8"
BHC240	BLUE	21,200	17,000	42,400	29,000	3'	1.37	1 3/4"
BHC300	ORANGE	25,000	20,000	50,000	35,000	4'	1.58	2"
BHC360	GREY	31,000	24,800	62,000	43,300	4'	1.79	2 1/4"
BHC400	ORANGE	40,000	32,000	80,000	56,500	6'	2.32	2 1/2"
BHC600	BROWN	53,000	42,400	106,000	74,000	6'	2.95	2 3/4"
BHC800	OLIVE	66,000	52,800	132,000	93,000	6'	3.58	3 1/8"
BHC1000	BLACK	90,000	72,000	180,000	127,000	6'	4.53	3 5/8"
BHC1100	BLACK	100,000	80,000	200,000	141,000	6'	5.15	4 1/4"
BHC1200	BLACK	110,000	88,000	220,000	155,000	8'	5.67	4 1/2"



WARNING: Do not exceed rated capacities. Sling capacity decreases as the angle from horizontal decreases. Slings should never be used at angles less than 30 degrees.



BIG EASY EYE & EYE ROUND SLING



An Eye & Eye Roundsling is made by adding an extra abrasion resistant sleeve to the body of a BRS. Can increase the life of the sling when abrasion to the body is an issue.

Features & Benefits:

- Additional abrasion resistance for the body of the sling
- Vertical, Choker & Basket Hitch
- Vertical Capacities from 2,600 lbs. to 100,000 lbs.

Manufacturing Tolerance:

+/-1" + 2% of specified length

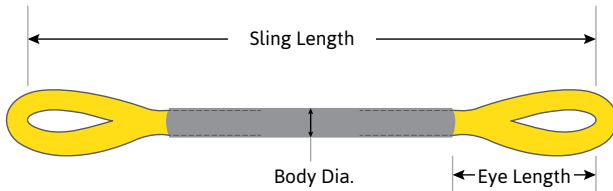

Part #	Color Code	RATED CAPACITY IN POUNDS				Min. Length	Weight Per Foot (lbs.)	Body DIA at Load	Standard Eye Length
		Vertical	Choker	Basket At 90°	Basket At 45°				
EEBRS30	PURPLE	2,600	2,100	5,200	3,600	3'	0.25	2.25"	12"
EEBRS60	GREEN	5,300	4,420	10,600	7,400	3'	0.36	2.5"	12"
EEBRS90	YELLOW	8,400	6,700	16,800	11,800	3'	0.55	2.5"	12"
EEBRS120	TAN	10,600	8,500	21,200	14,000	3'	0.65	3.5"	12"
EEBRS150	RED	13,200	10,600	26,400	18,000	3'	0.85	3.5"	14"
EEBRS180	WHITE	16,800	13,400	33,600	23,000	3'	0.95	3.5"	16"
EEBRS240	BLUE	21,200	17,000	42,400	29,000	3'	1.5	4.5"	16"
EEBRS300	ORANGE	25,000	20,000	50,000	35,000	4'	2	5.5"	18"
EEBRS360	GREY	31,000	24,800	62,000	43,300	4'	2.3	6"	20"
EEBRS400	ORANGE	40,000	32,000	80,000	56,500	4'	2.7	6"	24"
EEBRS600	BROWN	53,000	42,400	106,000	74,000	6'	3.3	7"	24"
EEBRS800	OLIVE	66,000	52,800	132,000	93,000	6'	3.9	8"	30"
EEBRS1000	BLACK	90,000	72,000	180,000	127,000	6'	4.8	9"	36"
EEBRS1100	BLACK	100,000	80,000	200,000	141,000	6'	5.3	9.5"	36"
EEBRS1200	BLACK	110,000	88,000	220,000	155,000	8'	5.77	9.75"	36"

* Larger Capacities Available. Please contact our office for a quote and more information.



WARNING: Do not exceed rated capacities. Sling capacity decreases as the angle from horizontal decreases. Slings should never be used at angles less than 30 degrees.



BIG EASY STAGE ROUNDSLING

Stage roundslings are designed for suspension applications where metal slings are required. The load-bearing member of a stage roundsling is made from steel galvanized aircraft cable. This wire core is encased in a black double-wall jacket that complies with all of the current rigging codes.

Features & Benefits:

- Standard Lengths Available
 - » 3', 4', 6' & 9'
- Saves Time and Money
 - » No backup rigging required
 - » Fewer components to inventory and carry
 - » Superior flexibility makes rigging easy
 - » Lowers show to show freight costs
- Increased Safety
 - » Improved cut resistance
 - » Higher heat resistance
 - » Conforms to load to grip securely



Overall Length



Part #	RATED CAPACITY IN POUNDS		
	Vertical	Choker	Basket At 90°
GACA60	5,300	4,200	10,600

* Custom Lengths Available Upon Request. Please contact our office for a quote and more information.



WARNING: Do not exceed rated capacities. Sling capacity decreases as the angle from horizontal decreases. Slings should never be used at angles less than 30 degrees.



BIG EASY BRIDLE ROUNDSLING

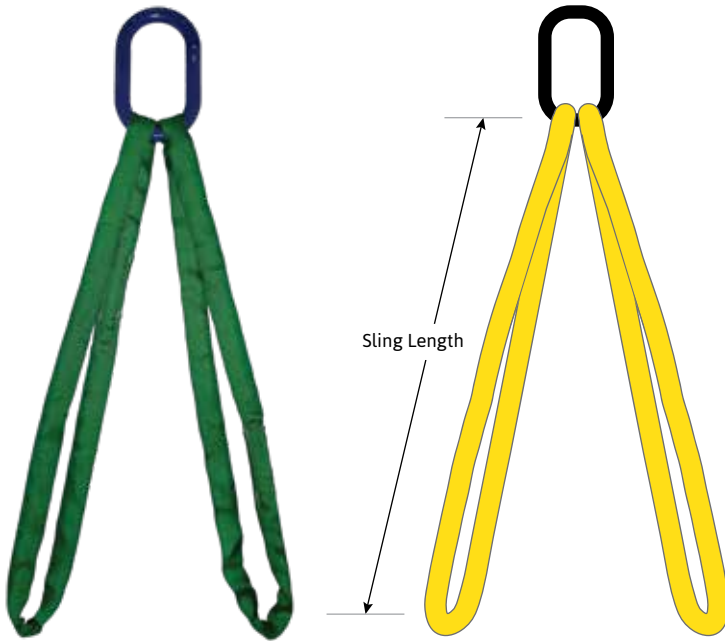

Roundslings Bridles are lightweight, pliable and can provide better load control and balance.

Features & Benefits:

- Can prevent cutting & abrasion at sling bearing points when using hardware
- Lightweight, Pliable
- Easier rigging and storage than wire rope and chain
- Better load control & balance
- Load bearing points can be rotated to extend life (when not built in eye/eye configuration)
- Low stretch: Approximately 3% at rated capacity
- Double Wall, Seamless Cover
 - » Helps protect core yarn from UV degradation
 - » Soft cover helps to prevent scratches to load surface
- Two sliding wear sleeves standard on all BHP slings

Manufacturing Tolerance:

+/-1" + 2% of specified length

BIG EASY BRIDLE ROUNDSLING ORDERING GUIDE

NUMBER OF LEGS		TOP ATTACHMENT		BOTTOM ATTACHMENT		LEG TYPE
S	SINGLE	O	OBLONG/MASTER LINK	O	OBLONG/MASTER LINK	EE EYE & EYE
D	DOUBLE	A	SUB ASSEMBLY	S	SLING HOOK*	
T	TRIPLE	S	SLING HOOK*	H	SHACKLE*	
Q	QUAD	H	SHACKLE*			
				*Note Type of Hook or Type of Shackle in Description		Leave Blank if Standard Legs Required

EXAMPLE PREFIXES:	DESCRIPTION
SOP	Single leg w/1 oblong on body
SOO	Single leg w/2 oblongs on body
SOS	Single leg w/oblong & sling hook on body
SSS	Single leg sling hook each end
DOP	Double leg oblong @ top
DOS	Double leg oblong @ top & sling hooks @ bottom
TOP	Triple leg oblong @ top
TOS	Triple leg oblong @ top & sling hooks @ bottom
QOP	Quadruple leg oblong @ top
QOS	Quadruple leg oblong @ top & sling hooks @ bottom

EXAMPLE:

A 4-Leg, BRS150 (RED) Big Easy Bridle Roundsling x 10' Long (Bearing to Bearing) with an Oblong Link & Alloy Sling Hooks

Number of Legs	Top Attachment	Bottom Attachment	(EE) For Eye/Eye	Leg(s)	Length
Q	O	S		BRS150	10

Part # to Order:
QOSBRS150X10



WARNING: Do not exceed rated capacities. Sling capacity decreases as the angle from horizontal decreases. Slings should never be used at angles less than 30 degrees.



BIG EASY BRIDLE ROUNDSLING

SINGLE LEG BRIDLE

	Part #	BRS30	BRS60	BRS90	BRS120	BRS150	BRS180	BRS240	BRS300	BRS360	BRS400	BRS600	BRS800	BRS1000
RATED CAPACITY IN LBS.	Vertical	2600	5300	8400	10600	13200	16800	21200	25000	31000	40000	53000	66000	90000
	Choker	2100	4240	6700	8500	10600	13400	17000	20000	24800	32000	42400	52800	72000
	Basket	5200	10600	16800	21200	26400	33600	42400	50000	62000	80000	106000	132000	180000
	Master Link	1/2"	3/4"	3/4"	3/4"	1"	1-1/4"	1-1/4"	1-1/2"	1-1/2"	1-3/4"	2"	2-1/4"	2-1/2"
	Alloy Hook	2T	5T	7T	11T	11T	15T	22T	37T	37T	45T	60T	N/A	N/A
	Carbon Hook	2T	3T	5T	7.5T	7.5T	10T	15T	25T	25T	30T	40T	N/A	N/A
	Sling Saver Hook	1.5T	3T	5T	5T	N/A	N/A	N/A	N/A	N/A	N/A	N/A	N/A	N/A
	Sling Saver Shackles	3-1/4T	3-1/4T	6-1/2T	6-1/2T	8-3/4T	8-3/4T	12-1/2T	12-1/2T	20-1/2T	20-1/2T	35T	35T	50T

TWO LEG BRIDLE

	Part #	BRS30	BRS60	BRS90	BRS120	BRS150	BRS180	BRS240	BRS300	BRS360	BRS400	BRS600	BRS800	BRS1000
RATED CAPACITY IN LBS.	Single Leg @ 90°	2600	5300	8400	10600	13200	16800	21200	25000	31000	40000	53000	66000	90000
	All Legs @ 60°	4500	9100	14500	18300	22800	29100	36700	43300	53700	69250	91800	114300	155800
	All Legs @ 45°	3600	7400	11800	14900	18600	23700	29900	35300	43800	56500	74900	93300	127200
	All Legs @ 30°	2600	5300	8400	10600	13200	16800	21200	25000	31000	40000	53000	66000	90000
	Master Link	1/2"	3/4"	1"	1-1/4"	1-1/4"	1-1/2"	1-1/2"	1-1/2"	2"	2"	2-1/2"	3"	3-1/4"
	Alloy Hook	2T	5T	7T	11T	11T	15T	22T	37T	37T	45T	60T	N/A	N/A
	Carbon Hook	2T	3T	5T	7.5T	7.5T	10T	15T	25T	25T	30T	40T	N/A	N/A
	Sling Saver Hook	1.5T	3T	5T	5T	N/A	N/A	N/A	N/A	N/A	N/A	N/A	N/A	N/A
	Sling Saver Shackles	3-1/4T	3-1/4T	6-1/2T	6-1/2T	8-3/4T	8-3/4T	12-1/2T	12-1/2T	20-1/2T	20-1/2T	35T	35T	50T

THREE LEG BRIDLE

	Part #	BRS30	BRS60	BRS90	BRS120	BRS150	BRS180	BRS240	BRS300	BRS360	BRS400	BRS600	BRS800	BRS1000
RATED CAPACITY IN LBS.	Single Leg @ 90°	2600	5300	8400	10600	13200	16800	21200	25000	31000	40000	53000	66000	90000
	All Legs @ 60°	6700	13700	21800	27500	34200	43600	55000	64900	80500	103850	137600	171400	233800
	All Legs @ 45°	5500	11200	17800	22400	27900	35600	44900	53000	65700	84850	112400	139900	190800
	All Legs @ 30°	3900	7900	12600	15900	19800	25200	31800	37500	46500	60000	75900	99000	135000
	Master Link	3/4"	1"	1-1/4"	1-1/2"	1-1/2"	1-3/4"	2"	2-1/4"	2-1/4"	2-1/2"	2-3/4"	3-1/2"	4-1/4"
	Sub Assembly	3/4"	1"	1-1/4"	1-1/2"	1-1/2"	1-3/4"	2"	2"	2-1/2"	2-1/2"	2-3/4"	2-3/4"	4"
	Alloy Hook	2T	5T	7T	11T	11T	15T	22T	37T	37T	45T	60T	N/A	N/A
	Carbon Hook	2T	3T	5T	7.5T	7.5T	10T	15T	25T	25T	30T	40T	N/A	N/A
	Sling Saver Hook	1.5T	3T	5T	5T	N/A	N/A	N/A	N/A	N/A	N/A	N/A	N/A	N/A
	Sling Saver Shackles	3-1/4T	3-1/4T	6-1/2T	6-1/2T	8-3/4T	8-3/4T	12-1/2T	12-1/2T	20-1/2T	20-1/2T	35T	35T	50T

FOUR LEG BRIDLE

	Part #	BRS30	BRS60	BRS90	BRS120	BRS150	BRS180	BRS240	BRS300	BRS360	BRS400	BRS600	BRS800	BRS1000
RATED CAPACITY IN LBS.	Single Leg @ 90°	2600	5300	8400	10600	13200	16800	21200	25000	31000	40000	53000	66000	90000
	All Legs @ 60°	9000	18300	29100	36700	45700	58200	73400	86500	107300	138500	183600	228600	311700
	All Legs @ 45°	7300	14900	23700	29900	37300	47500	59900	70700	87600	113100	149900	186600	254500
	All Legs @ 30°	5200	10600	16800	21200	26400	33600	42400	50000	62000	80000	106000	132000	180000
	Master Link	3/4"	1-1/4"	1-1/2"	1-1/2"	1-3/4"	2"	2-1/4"	2-3/4"	2-3/4"	3"	3-1/2"	4-1/4"	4-3/4"
	Sub Assembly	3/4"	1"	1-1/4"	1-1/2"	1-1/2"	1-3/4"	2"	2"	2-1/2"	2-1/2"	2-3/4"	4"	4"
	Alloy Hook	2T	5T	7T	11T	11T	15T	22T	37T	37T	45T	60T	N/A	N/A
	Carbon Hook	2T	3T	5T	7.5T	7.5T	10T	15T	25T	25T	30T	40T	N/A	N/A
	Sling Saver Hook	1.5T	3T	5T	5T	N/A	N/A	N/A	N/A	N/A	N/A	N/A	N/A	N/A
	Sling Saver Shackles	3-1/4T	3-1/4T	6-1/2T	6-1/2T	8-3/4T	8-3/4T	12-1/2T	12-1/2T	20-1/2T	20-1/2T	35T	35T	50T

* Custom Options Available. Please contact our office for more information



WARNING: Do not exceed rated capacities. Sling capacity decreases as the angle from horizontal decreases. Slings should never be used at angles less than 30 degrees.



BIG EASY FLOW LINE RESTRAINT



Polyester Restraints are constructed similar to an Endless Polyester Roundslings. They are constructed using a continuous loop of core yarns encased in a double wall cover. This cover helps to protect the load bearing yarn from abrasion.

Restraints can use similar color codes as standard roundslings (Lifting Slings) but Polyester Flow Line restraints do offer different capacities than a standard roundslings.

Restraints are not to be used for Overhead Lifting

Features & Benefits:

- Lightweight: Easy to use, versatile, high strength-to-weight ratio
- Restraints designed for 2", 3" & 4" Iron
- Rated in PSI and/or Break Strength
- Color Coded to allow for quick identification (Custom Colors Available)
- Private Label Available
- Double Wall, Seamless Cover
 - » Helps protect core yarn from UV degradation and Abrasion

Manufacturing Tolerance:

+/- 1" + 2% of specified length

Proper Use of Restraints can reduce **But Not Eliminate** the risk of severe personal injury or death.

Part #	Color Code	Max PSI – 2" 1502	Max PSI – 3" 1502	Max PSI – 4" 1502
BFR78	RED	15,000	8,000	5,000
BFR160	BLUE	20,000	15,000	10,000
BFR200	ORANGE	20,000	15,000	15,000

WEB SLING INFORMATION

Common Types of Sling Hitches

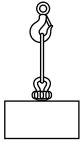
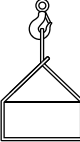
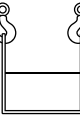
Hitch	Comments
 <p>Vertical Hitch</p>	One end is placed on the hook, while the other end is attached directly to the load. A tagline should be used to prevent load rotation.
 <p>Choker Hitch</p>	Sling passes through one end around the load and the other end is placed on the hook. Rated capacity is normally 80% of that for a vertical hitch. Load control is a potential problem with only one sling rigged in a choker hitch. Also, the choke point should always be on the sling body—not on the fittings, base of the fitting or tag.
 <p>Basket Hitch</p>	The sling cradles the load while both ends are attached overhead. The rated capacity for a basket hitch is twice that for a vertical hitch. As with the choker hitch, more than one sling rigged in a basket hitch (or some other means) may be necessary to help ensure load control.

Increased sling tension as a function of sling-to-load angle

Angle "A" in degrees from horizontal	Tension Multiplier
90	1.000
85	1.004
80	1.015
75	1.035
70	1.064
65	1.104
60	1.155
55	1.221
50	1.305
45	1.414
40	1.555
35	1.742
30	2.000

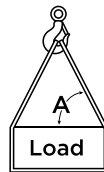

Multiply the load weight (per leg) by the tension factor to determine the increased tension of the sling leg(s)

Reductions in rated capacity as a function of angle of choke

Angle of Choke (degrees)		Angle of Choke Reduction Factor
= or >	<	
120	180	1.000
105	120	0.82
90	105	0.71
60	90	0.58
0	60	0.50

Actual Sling Capacity = Rated Capacity x Reduction Factor

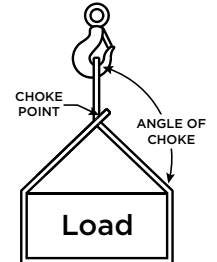

The radii values apply to roundslings that are fully tensioned to their rated capacity regardless of the hitch.

When roundslings are tensioned to lower force values, the minimum radius values will reduce accordingly.

Fractional inches are rounded up to the nearest 1/16" (1.58 mm).

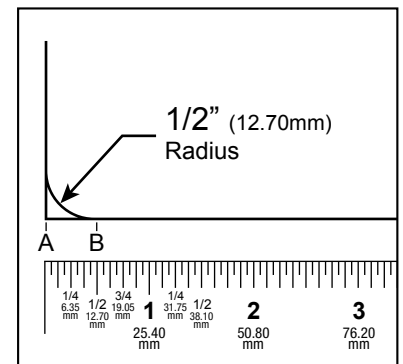

Web Sling Removal from Service Criteria

- If sling identification tag is missing or not readable.
- Holes, tears, cuts, snags, or embedded materials.
- Broken or worn stitches in the load bearing splices.
- Knots in any part of the sling webbing.
- Acid or alkali burns
- Melting, charring or weld spatter on any part of the web sling.
- Excessive abrasive wear or crushed webbing.
- Signs of Ultraviolet (UV) light degradation.
- Distortion, excessive pitting, corrosion or other damage to fitting(s).
- If provided, exposed red core yarn. However, if damage is present and red yarns are not exposed DO NOT USE the sling.
- Any conditions which cause doubt as to the strength of the web sling.

WHERE TO FIND ADDITIONAL INFORMATION:

- WSTDA-WS-1 – RECOMMENDED STANDARD SPECIFICATION FOR SYNTHETIC POLYESTER WEB SLINGS
- WSTDA-WS-2 – RECOMMENDED OPERATING, CARE AND INSPECTION MANUAL FOR NYLON & POLYESTER SYNTHETIC WEB SLINGS
- ASME B30.9 – SYNTHETIC WEBBING SLINGS: SELECTION, USE AND MAINTENANCE
- OSHA GUIDANCE ON SAFE SLING USE ([HTTP://WWW.OSHA.GOV/DSG/GUIDANCE/SLIDES/SYNTH-WEB.HTML](http://www.osha.gov/dsg/guidance/slides/synth-web.html))
- OSHA 29 CFR 1910.184 - SLINGS
- RIGGING HANDBOOKS
- FORMAL TRAINING FROM CERTIFIED THIRD PARTY OR MANUFACTURE



TYPES OF WEBBING

MATERIAL TYPES:

P
Polyester
Webbing



PDE
Polyester
Defense
Edge



N
Nylon
Webbing



NYLON VS POLYESTER

- Nylon and Polyester materials are heavy webbing designed to perform in tough industrial conditions. Both perform equally well in many applications, but as you can see below each is designed for specific conditions.
- Nylon will stretch about 6% when loaded while Polyester will stretch roughly 3% and water absorption is low for both material.
- Neither Nylon or Polyester should be exposed to heat exceeding 194° F (90° C) or below -40° F (-40° C).

CHEMICAL	NYLON	POLYESTER
ACIDS	NO	*
ALCOHOL	OK	OK
ALDEHYDES	OK	NO
STRONG ALKALIS	OK	NO
BLEACHING AGENTS	NO	OK
DRY CLEANING SOLVENTS	OK	OK
ETHERS	OK	OK
HALOGENATED HYDRO-CARBONS	OK	OK
HYDRO-CARBONS	OK	OK
KETONES	OK	OK
OILS CRUDE	OK	OK
OILS LUBRICATING	OK	OK
SOAPS & DETERGENTS	OK	OK
WATER & SEAWATER	OK	OK
WEAK ALKALIS	OK	OK

**DISINTEGRATED BY CONCENTRATED SULFURIC ACID.*

HOW TO ORDER WEB SLINGS

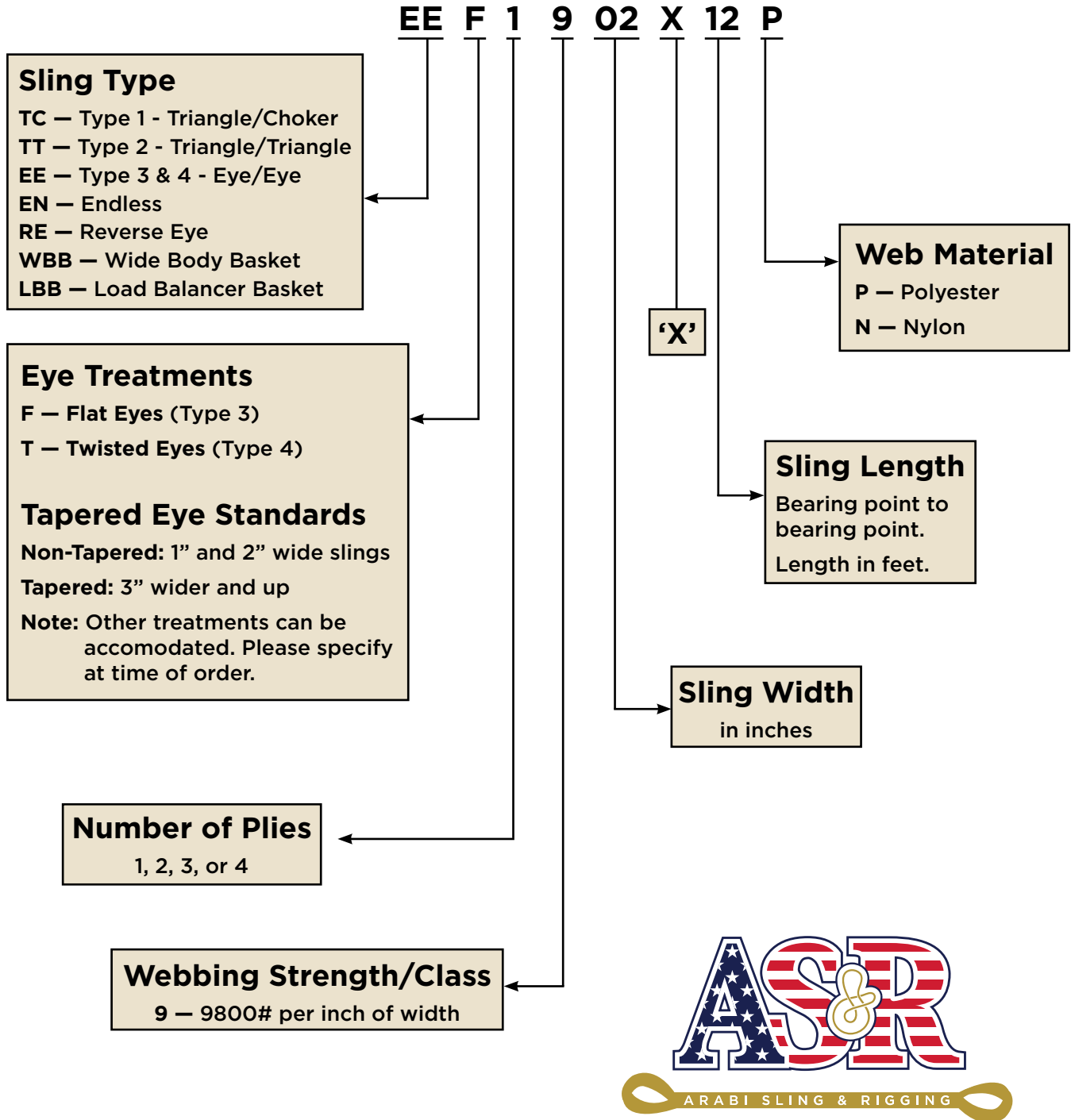

TRIANGLE / TRIANGLE AND TRIANGLE / CHOKER WEB SLING

		RATED CAPACITY IN POUNDS			
Type 1 TCA(S) Type 2 TTA(S)		Vertical	Choker	Basket Hitch @ 90°	Web Width
ONE PLY	1902	3,100	2,480	6,200	2"
	1903	4,700	3,760	9,400	3"
	1904	6,200	4,960	12,400	4"
	1905	7,800	6,240	15,600	5"
	1906	9,300	7,440	18,600	6"
	1908	11,800	9,440	23,600	8"
	1910	14,700	11,760	29,400	10"
	1912	17,600	14,080	35,200	12"
TWO PLY	2902	6,200	4,960	12,400	2"
	2903	8,800	7,040	17,600	3"
	2904	11,000	8,800	22,000	4"
	2905	13,700	10,960	27,400	5"
	2906	16,500	13,200	33,000	6"
	2908	22,700	18,160	45,400	8"
	2910	28,400	22,720	56,800	10"
	2912	34,100	27,280	68,200	12"



TRIANGLE / CHOKER

- Steel or Aluminum end fittings available
- Easily used in Basket and Choker Hitches
- Fittings help reduce abrasion
- Can create easier connection to hoist hooks
- Steel fitting provided as a standard on 2-Ply & 4-Ply slings



TRIANGLE / TRIANGLE

- Steel or Aluminum end fittings available
- Easily used in Basket and Vertical – Not used for Choker Hitch
- Fittings help reduce abrasion
- Can create easier connection to hoist hooks
- Steel fitting provided as a standard on 2-Ply & 4-Ply slings

WARNING: Do not exceed rated capacities. Sling capacity decreases as the angle from horizontal decreases. Slings should never be used at angles less than 30 degrees. Fittings should never be used where exposure to sprays, mists, vapors, fumes or liquids of harmful acids, alkalis, chlorine or other corrosive agents are present. While aluminum fittings are non-sparking and do not rust, they are not as durable and cost more than steel hardware. Aluminum fittings are degraded by salt water and should not be cleaned with chlorine based solutions.

WARNING: Do not exceed rated capacities. Sling capacity decreases as the angle from horizontal decreases. Slings should never be used at angles less than 30 degrees.

TRIANGLE / TRIANGLE AND TRIANGLE / CHOKER WEB SLING HARDWARE SPECIFICATIONS

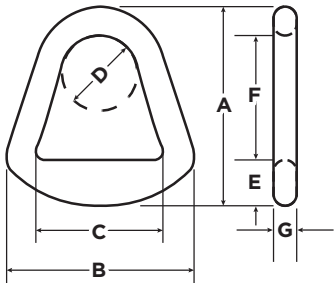

TRIANGLES 2-PLY DIMENSIONS & DATA

Size	A	B	C	D	E	F	G	Approx. Weight (lbs.)	W.L.L.	Min. Break Strength
ST2	3-7/8	3-3/4	2-1/8	1-3/4	1	2-5/16	1/2	1	6,600	33,000
ST3	5-3/16	5	3-1/16	2	1-1/4	3-5/16	1/2	1.6	8,900	44,500
ST4	6-7/16	6-5/8	4-5/16	2	1-5/8	3-7/8	1/2	2.7	11,600	58,000
ST5	7-7/8	7-15/16	5-3/16	2-1/2	2	4-15/16	1/2	3.5	14,000	70,000
ST6	9	9-1/4	6-1/8	2-3/4	2-5/16	5-9/16	1/2	5.3	16,800	84,000
ST8	11-7/15	12	8-1/4	3-5/8	2-7/8	7-3/16	3/4	12	22,400	112,000
ST10	13-1/4	14-1/8	10-1/8	4-7/8	3-5/8	8-1/4	3/4	17	28,000	140,000
ST12	12-13/16	16-7/16	12-3/8	5	4-1/16	8	3/4	19	32,000	160,000

TRIANGLES 4-PLY DIMENSIONS & DATA

Size	A	B	C	D	E	F	G	Approx. Weight (lbs.)	W.L.L.	Min. Break Strength
ST2	4-5/16	3-7/8	2-3/16	1-5/8	1-1/8	2-3/8	1/2	2.0	11,800	59,200
ST3	5-1/2	5.3/4	3-3/16	2-1/4	1-3/8	3-5/16	3/4	2.5	17,800	88,800
ST4	6-1/2	6-3/4	4-3/16	2-1/2	1-13/16	3-3/4	3/4	4.5	25,000	115,200
ST5	7-15/16	8	5-1/4	2-3/4	2-1/8	5	3/4	5.3	28,000	140,000
ST6	9-1/16	9-5/16	6-1/4	3	2-5/16	5-1/2	1	10.0	32,700	163,200
ST8	12-1/16	12-3/16	8-1/4	3-3/4	3-3/16	7-1/4	1-1/4	18.0	46,100	230,400
ST10	13-5/16	14-3/8	10-1/4	4-3/4	3-13/16	8-1/16	1-1/2	35.0	57,600	288,000
ST12	14-11/16	16-3/4	12-3/8	5-3/4	4-3/8	8-5/16	1-1/2	40.0	65,300	326,400

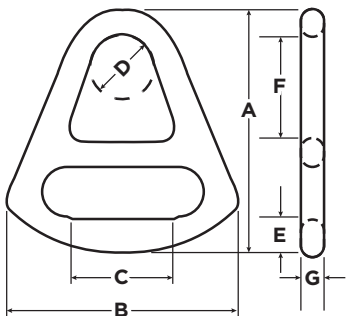

CHOKERS 2-PLY DIMENSIONS & DATA

Size	A	B	C	D	E	F	G	Approx. Weight (lbs.)	W.L.L.	Min. Break Strength
ST2	6	5-1/2	2-1/8	2	1-1/16	2-1/4	1/2	2	6,600	33,000
ST3	7-1/2	7	3-1/8	2	1-3/16	3-3/16	1/2	2.9	8,900	44,500
ST4	9-5/16	9-9/16	4-1/8	2-1/2	1-13/16	3-1/2	1/2	6	11,600	58,000
ST5	10-9/16	11-5/8	5-1/8	2-3/4	2-1/16	4-7/16	1/2	7	14,000	70,000
ST6	12	12-3/4	6-1/8	2-7/8	2-11/16	4-9/16	1/2	9.8	16,800	84,000
ST8	14-7/16	16-1/2	8-1/8	5	2-13/16	6-7/16	3/4	24	22,400	112,000
ST10	16-1/2	18-3/4	10-1/4	5-1/8	3-1/2	7-5/8	3/4	28	28,000	140,000
ST12	19-1/4	22-5/8	12-1/8	5-1/2	4-1/4	9-3/4	3/4	40	32,000	160,000

CHOKERS 4-PLY DIMENSIONS & DATA

Size	A	B	C	D	E	F	G	Approx. Weight (lbs.)	W.L.L.	Min. Break Strength
ST2	7	5-7/8	2-1/4	2	1-1/8	2-5/16	1/2	3	11,800	59,200
ST3	8-3/4	7-7/8	3-1/4	2	1-5/16	3-5/16	3/4	5.5	17,800	88,800
ST4	9-5/16	9-13/16	4-1/4	2-3/4	1-11/16	3-3/4	3/4	9.0	25,000	115,200
ST5	10-7/8	12	5-1/4	2-7/8	2-3/16	4-1/2	3/4	18.5	28,000	140,000
ST6	12-3/8	12-3/4	6-1/4	3	2-5/8	5-1/4	1	19	32,700	163,200
ST8	14-9/16	16-5/8	8-1/4	4-3/4	2-3/4	6-1/2	1-1/4	44	46,100	230,400
ST10	17-3/8	19-5/8	10-1/4	5-1/4	3-7/8	7-9/16	1-1/2	67	57,600	288,000
ST12	19-5/8	23-3/16	12-1/4	5-1/2	4	9-7/8	1-1/2	89	65,300	326,400



WARNING: Do not exceed rated capacities. Sling capacity decreases as the angle from horizontal decreases. Slings should never be used at angles less than 30 degrees.

FLAT & TWISTED EYE/EYE WEB SLING



	RATED CAPACITY IN POUNDS				Web Width	Eye Length	Eye Width
	Type 3 EEF Type 4 EET	Vertical	Choker	Basket Hitch @ 90°			
ONE PLY	1901	1,600	1,280	3,200	1"	9"	1"
	1902	3,100	2,480	6,200	2"	9"	2"
	1903	4,700	3,760	9,400	3"	12"	1.5"
	1904	6,200	4,960	12,400	4"	14"	2"
	1906	9,300	7,440	18,600	6"	18"	2"
	1908	11,800	9,440	23,600	8"	22"	3"
	1910	14,700	11,760	29,400	10"	28"	3.5"
	1912	17,600	14,080	35,200	12"	30"	4"
TWO PLY	2901	3,100	2,480	6,200	1"	9"	1"
	2902	6,200	4,960	12,400	2"	9"	2"
	2903	8,800	7,040	17,600	3"	12"	1.5"
	2904	11,000	8,800	22,000	4"	14"	2"
	2906	16,500	13,200	33,000	6"	18"	2"
	2908	22,700	18,160	45,400	8"	22"	3"
	2910	28,400	22,720	56,800	10"	28"	3.5"
	2912	34,100	27,280	68,200	12"	30"	4"
THREE PLY	3901	4,700	3,760	9,400	1"	12"	1"
	3902	9,300	7,440	18,600	2"	12"	2"
	3903	13,500	10,800	27,000	3"	14"	1.5"
	3904	17,200	13,760	34,400	4"	18"	2"
	3906	24,400	19,520	48,800	6"	24"	3"
	3908	30,700	24,560	61,400	8"	26"	4"
	3910	36,000	28,800	72,000	10"	30"	5"
	3912	40,300	32,240	80,600	12"	42"	6"
FOUR PLY	4901	5,500	4,400	11,000	1"	12"	1"
	4902	11,000	8,800	22,000	2"	12"	2"
	4903	16,400	13,120	32,800	3"	14"	1.5"
	4904	20,400	16,320	40,800	4"	18"	2"
	4906	30,800	24,640	61,600	6"	26"	3"
	4908	41,000	32,800	82,000	8"	28"	4"
	4910	48,000	38,400	96,000	10"	32"	5"
	4912	60,000	48,000	120,000	12"	44"	6"

Features & Benefits:

- Can be used in a Vertical, Choker or Basket Hitch
- Flat Eyes (Type 3 / EEF) are standard, Half Twist Eyes (Type 4 / EET) provided upon request
- Available in widths ranging from 1" to 12"
- Available in 1-Ply thru 4-Ply
- Bearing point of sling eyes are tapered to a narrower width on 3" and wider as a standard
- Tapered eyes on 2" wide slings are available upon request
- Additional wear protection is recommended in the eyes and/or on the body of the sling
- Polyester provided as a standard, Nylon available upon request

Sling Thickness	Tolerance
1 PLY	+/- 1.5" + 1.5% of Sling Length
2 PLY	+/- 2" + 2% of Sling Length
3 & 4 PLY	+/- 3" + 3% of Sling Length

Consider using Roundslings in applications requiring 3-Ply or 4-Ply slings, wider than 6"



WARNING: Do not exceed rated capacities. Sling capacity decreases as the angle from horizontal decreases. Slings should never be used at angles less than 30 degrees.

ENDLESS WEB SLING

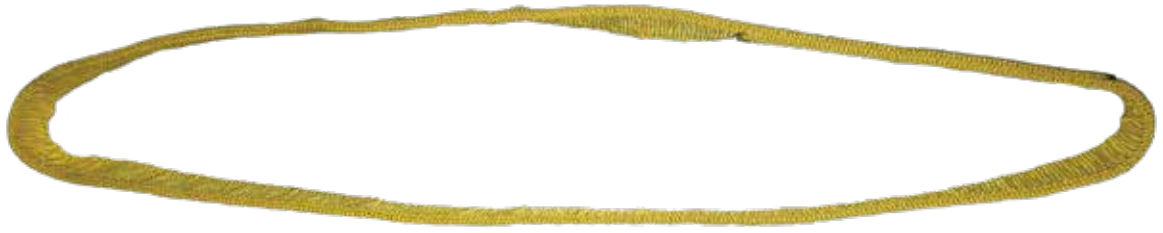

Features & Benefits:

- One of the most versatile web slings available
- Can be used in a Vertical, Choker or Basket Hitch
- Easily rotated to adjust bearing points and account for wear
- Available in widths ranging from 1" to 12"
- Available in 1-Ply thru 4-Ply
- Additional wear protection is recommended
- Polyester provided as a standard, Nylon available upon request

Sling Thickness	Tolerance
1 PLY	+/- 1.5" + 1.5% of Sling Length
2 PLY	+/- 2" + 2% of Sling Length
3 & 4 PLY	+/- 3" + 3% of Sling Length

		RATED CAPACITY IN POUNDS				
		Type 5 EN	Vertical	Choker	Basket Hitch @ 90°	Web Width
ONE PLY	1901	3,200	2,560	6,400	1"	
	1902	6,200	4,960	12,400	2"	
	1903	9,400	7,520	18,800	3"	
	1904	12,400	9,920	24,800	4"	
	1906	18,600	14,880	37,200	6"	
	1908	21,200	16,960	42,400	8"	
	1910	26,500	21,200	53,000	10"	
	1912	31,800	25,440	63,600	12"	
TWO PLY	2901	6,200	4,960	12,400	1"	
	2902	12,400	9,920	24,800	2"	
	2903	17,600	14,080	35,200	3"	
	2904	22,000	17,600	44,000	4"	
	2906	33,000	26,400	66,000	6"	
	2908	42,300	33,840	84,600	8"	
	2910	52,900	42,320	105,800	10"	
	2912	63,500	50,800	127,000	12"	
THREE PLY	3901	9,600	7,680	19,200	1"	
	3902	17,700	14,160	35,400	2"	
	3903	25,600	20,480	51,200	3"	
	3904	34,600	27,680	69,200	4"	
	3906	48,900	39,120	97,800	6"	
	3908	61,400	49,120	122,800	8"	
	3910	72,000	57,600	144,000	10"	
	3912	80,600	64,480	161,200	12"	
FOUR PLY	4901	11,000	8,800	22,000	1"	
	4902	22,000	17,600	44,000	2"	
	4903	32,900	26,320	65,800	3"	
	4904	40,800	32,640	81,600	4"	
	4906	61,200	48,960	122,400	6"	
	4908	81,900	65,520	163,800	8"	
	4910	96,000	76,800	192,000	10"	
	4912	107,000	85,600	214,000	12"	

Consider using Roundslings in applications requiring 3-Ply or 4-Ply slings, wider than 6"



WARNING: Do not exceed rated capacities. Sling capacity decreases as the angle from horizontal decreases. Slings should never be used at angles less than 30 degrees.

REVERSE EYE & FLAT EYE WEB SLING



REVERSED EYE

- Body and Eyes are covered with Bulkied Nylon
- Easy to use in Choker or Basket Hitches
- Bearing point of the eyes are 90° to the sling body
- Available in 2", 3", 4" & 6" widths
- 2" wide slings available in 1-Ply & 2-Ply
- 4" & Wider Available in 1-Ply thru 4-Ply

FLAT EYE

- Body and Eyes are covered with Bulkied Nylon
- Easy to use in Vertical, Choker or Basket Hitches
- The Eyes lay flat and are in the same plane as the sling
- Available in 2", 3", 4" & 6" widths
- 2" wide slings available in 1-Ply & 2-Ply
- 4" & Wider Available in 1-Ply thru 4-Ply

		RATED CAPACITY IN POUNDS					
	Type 6 (RE) Type 7 (FE)	Vertical	Choker	Basket Hitch @ 90°	Sling Width	Eye Length	Eye Width
ONE PLY	1902	3,200	2,560	6,400	2"	9"	1"
	1903	4,600	3,680	9,200	3"	12"	1.5"
	1904	6,200	4,960	12,400	4"	12"	2"
	1906	9,400	7,520	18,800	6"	15"	3"
TWO PLY	2902	6,200	4,960	12,400	2"	12"	1"
	2903	9,200	7,360	18,400	3"	15"	1.5"
	2904	12,400	9,920	24,800	4"	15"	2"
	2906	17,600	14,080	35,200	6"	18"	3"

Sling Thickness	Tolerance
1 PLY	+/- 1.5" + 1.5% of Sling Length
2 PLY	+/- 2" + 2% of Sling Length
3 & 4 PLY	+/- 3" + 3% of Sling Length



WARNING: Do not exceed rated capacities. Sling capacity decreases as the angle from horizontal decreases. Slings should never be used at angles less than 30 degrees.

BRIDLE WEB SLING

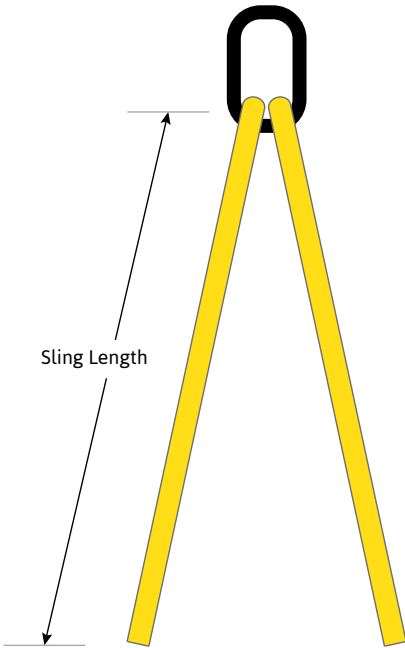

Part # for Legs	Web Width	Web Plies	# of Legs	RATED CAPACITY (LBS.)				Alloy Sling Hook	Oblong Link
				VERT	60°	45°	30°		
EE1901	1"	1	SINGLE	1600	-	-	-	1.5T Sling Saver	1/2"
	1"	1	DOUBLE	-	2700	2200	1600	1.5T Sling Saver	1/2"
	1"	1	TRIPLE	-	4100	3300	2400	1.5T Sling Saver	3/4"
	1"	1	QUAD	-	5500	4500	3200	1.5T Sling Saver	1"
EE2901	1"	2	SINGLE	3100	-	-	-	1.5T Sling Saver	1/2"
	1"	2	DOUBLE	-	5300	4300	3100	1.5T Sling Saver	3/4"
	1"	2	TRIPLE	-	8000	6500	4600	1.5T Sling Saver	3/4"
	1"	2	QUAD	-	10700	8700	6200	1.5T Sling Saver	1"
EE1902	2"	1	SINGLE	3100	-	-	-	1.5T Sling Saver	1/2"
	2"	1	DOUBLE	-	5300	4300	3100	1.5T Sling Saver	3/4"
	2"	1	TRIPLE	-	8000	6500	4600	1.5T Sling Saver	3/4"
	2"	1	QUAD	-	10700	8700	6200	1.5T Sling Saver	1"
EE2902	2"	2	SINGLE	6200	-	-	-	3T	3/4"
	2"	2	DOUBLE	-	10700	8700	6200	3T	1"
	2"	2	TRIPLE	-	16100	13100	9300	3T	1"
	2"	2	QUAD	-	21400	17500	12400	3T	1-1/4"

BRIDLE WEB SLING ORDERING GUIDE

NUMBER OF LEGS		TOP ATTACHMENT		BOTTOM ATTACHMENT		LEG TYPE	
S	SINGLE	O	OBLONG/MASTER LINK	O	OBLONG/MASTER LINK	EE	EYE & EYE
D	DOUBLE	A	SUB ASSEMBLY	S	SLING HOOK*		
T	TRIPLE	S	SLING HOOK*	H	SHACKLE*		
Q	QUAD	H	SHACKLE*				

*Note Type of Hook or Type of Shackle in Description

*Note Type of Hook or Type of Shackle in Description

Leave Blank if Standard Legs Required

EXAMPLE PREFIXES:	DESCRIPTION
SOO	Single leg oblong each end
SOE	Single leg oblong one end, sewn eye other end
SOS	Single leg oblong one end, sling hook other end
SSS	Single leg sling hook each end
DOE	Double leg oblong @ top & sewn eyes at bottom
DOS	Double leg oblong @ top & sling hooks in bottom eyes
TOE	Triple leg oblong @ top & sewn eyes at bottom
TOS	Triple leg oblong @ top & sling hooks in bottom eyes
QOE	Quadruple leg oblong @ top & sewn eyes at bottom
QOS	Quadruple leg oblong @ top & sling hooks in bottom eyes

EXAMPLE:

A 2-Leg, Single Ply, 1" Wide Polyester Web Bridle x 10' long (Bearing to Bearing) with an Oblong Link in the Top Eyes & Sling Hooks in the Bottom Eyes

Prefix	Leg(s)	Length	Material
DOS	EE1901	10	P

Part # to Order:
DOSEE1901X10P



WARNING: Do not exceed rated capacities. Sling capacity decreases as the angle from horizontal decreases. Slings should never be used at angles less than 30 degrees.

WIDE BODY BASKET SLING



		RATED CAPACITY IN POUNDS			
	Type 8 (WBB) Part #	Basket Hitch @ 90°	Eye Length	Eye Width	Finished Sling Width
ONE PLY	WBB1906	18,800	12"	1-1/2"	6"
	WBB1908	24,800	12"	2"	8"
	WBB1910	31,200	15"	1-3/4"	10"
	WBB1912	37,200	15"	2"	12"
	WBB1916	42,400	18"	3"	16"
	WBB1920	53,000	24"	3-1/2"	20"
	WBB1924	63,600	24"	4"	24"
TWO PLY	WBB2906	35,200	15"	1-1/2"	6"
	WBB2908	44,000	15"	2"	8"
	WBB2910	54,800	18"	2-1/2"	10"
	WBB2912	66,600	18"	3"	12"
	WBB2916	84,000	24"	4"	16"
	WBB2920	105,800	24"	5"	20"
	WBB2924	127,000	30"	6"	24"

3-Ply & 4-Ply Available Upon Request

Features & Benefits:

- Basket Hitch Only
- Provides better balance for large fragile loads or highly finished surfaces
- Stiffeners at base of eye to prevent webbing from folding
- Eyes are tapered for easier fit in hoist or crane hooks
- Non-abrasive webbing reduces marring on painted and plated surfaces
- Komodo Cover Available

Sling Thickness	Tolerance
1 PLY	+/- 1.5" + 1.5% of Sling Length
2 PLY	+/- 2" + 2% of Sling Length

LOAD BALANCER BASKET SLING



		RATED CAPACITY IN POUNDS			
	Type 9 (LBB) Part #	Basket Hitch @ 90°	Eye Length	Eye Width	Finished Sling Width
ONE PLY	LBB1906	3,000	10"	1"	6"
	LBB1908	3,000	10"	1"	8"
	LBB1910	3,000	12"	1"	10"
	LBB1912	3,000	12"	1"	12"
	LBB1916	5,000	12"	2"	16"
	LBB1920	5,000	18"	2"	20"
	LBB1924	5,000	18"	2"	24"
TWO PLY	LBB2906	6,000	10"	1"	6"
	LBB2908	6,000	10"	1"	8"
	LBB2910	6,000	12"	1"	10"
	LBB2912	6,000	12"	1"	12"
	LBB2916	10,000	12"	2"	16"
	LBB2920	10,000	18"	2"	20"
	LBB2924	10,000	18"	2"	24"

Features & Benefits:

- Basket Hitch Only
- Lower rated capacity than Wide Body Slings
- Provides better balance for lighter, fragile loads or highly finished surfaces
- Stiffeners at base of eye to prevent webbing from folding
- Eyes are manufactured for easier fit in smaller hoist hooks
- Non-abrasive webbing reduces marring on painted and plated surfaces
- Komodo Cover Available

Sling Thickness	Tolerance
1 PLY	+/- 1.5" + 1.5% of Sling Length
2 PLY	+/- 2" + 2% of Sling Length



WARNING: Do not exceed rated capacities. Sling capacity decreases as the angle from horizontal decreases. Slings should never be used at angles less than 30 degrees.

STONE HANDLING SLING

These slings are made with untreated, white nylon webbing. The webbing also features a soft, abrasion resistant fabric woven on one side. Stone Handling Slings are designed for handling concrete panels, polished granite and marble blocks.

Part #	Ply	Vertical (lbs.)	Choker (lbs.)	Basket (lbs.)
EESH104N	1	5,400	4,100	10,800
ENSH104N	1	10,800	8,600	21,600
EESH204N*	2	9,400	7,100	18,800
ENSH204N*	2	10,800	8,600	21,600

*2-Ply Sling offers Abrasion Resistance on both sides.

HOSE HANDLING SLING

Designed to be used in a Choker Hitch and to prevent any crushing or kinking of the hose, these slings distribute the load over the width of the sling. Hose Handling Slings are made using 9800 lbs. polyester webbing, unless a different material is specified.

Part #	Hose Dia.	Sling Length	Choker Capacity (lbs.)
AHH1904P	4"	3'6"	2,600
AHH1906P	6"	4'6"	5,100
AHH1908P	8"	6'	5,800
AHH1910P	10"	9'	7,700
AHH1912P	12"	11'	7,700

- TACO SLING
- DIRT/TRASH SLING
- GAS BOTTLE HANDLER
- DRUM HANDLING SLING



Call our Sales Team for additional Specialty Item Requests



WARNING: Do not exceed rated capacities. Sling capacity decreases as the angle from horizontal decreases. Slings should never be used at angles less than 30 degrees.

WEB RECOVERY STRAP

Features & Benefits:

- Made in USA
- Non-abrasive nylon webbing reduces marring on painted and plated surfaces
- Soft, Pliable, Lightweight and Easy to handle
- No hooks or metal parts
- Special Material options available upon request
- Komodo Cover or Additional Sleeves Available



Part #	End Fittings	Width	Length	Breaking Strength* (lbs.)
AWRN1902	Lined Eyes	2"	20'	16000
AWRN2902	Lined Eyes	2"	20'	32000
AWRN1904	Lined Eyes	4"	20'	32000
AWRN2904	Lined Eyes	4"	20'	58000

*Breaking strength when new.



Safe Operating Practices:

Inspect before each use. Do not exceed rated capacity. Avoid dragging strap on ground. Do not attach to bumpers. Do not tie knots in sling. Avoid temperatures in excess of 200°. Always protect straps from being cut by corners and edges. Stand clear of strap and vehicles when under load.



WARNING: Do not exceed rated capacities. Sling capacity decreases as the angle from horizontal decreases. Slings should never be used at angles less than 30 degrees. *The breaking strengths shown are based on new recovery straps under ideal test conditions using WSTDA recommended pin diameters at each end of the recovery strap. Smaller pin diameters, corners or edges exposed to the recovery strap, and shock loading (jerking of the recovery strap under load) can greatly reduce the breaking strength ratings. Check with the manufacturer for your specific application.

BIG EASY EYE/EYE RECOVERY STRAP

Features & Benefits:

- Made in USA
- Sling made with heavy duty double wall nylon cover
- 2' Buffer Sleeve included on body of sling for additional bearing point protection when used in basket hitch
- Non-abrasive nylon cover reduces marring on painted and plated surfaces
- Soft, Pliable, Lightweight and Easy to handle
- No hooks or metal parts



Part #	Outer Cover Color	Eye Length	Sling Length	Breaking Strength* (lbs.)
EEBRNC90	GRAY	2'	20'	42000
EEBRNC120	GRAY	2'	20'	52500
EEBRNC150	GRAY	2'	20'	66000
EEBRNC240	GRAY	2'	20'	106000
EEBRNC360	GRAY	2'	20'	155000

*Breaking strength when new.



Safe Operating Practices:

Inspect before each use. Do not exceed rated capacity. Avoid dragging strap on ground. Do not attach to bumpers. Do not tie knots in sling. Avoid temperatures in excess of 200°. Always protect straps from being cut by corners and edges. Stand clear of strap and vehicles when under load.



WARNING: Do not exceed rated capacities. Sling capacity decreases as the angle from horizontal decreases. Slings should never be used at angles less than 30 degrees. *The breaking strengths shown are based on new recovery straps under ideal test conditions using WSTDA recommended pin diameters at each end of the recovery strap. Smaller pin diameters, corners or edges exposed to the recovery strap, and shock loading (jerking of the recovery strap under load) can greatly reduce the breaking strength ratings. Check with the manufacturer for your specific application.

WEAR PROTECTION

AS&R can provide both Cut Protection and Wear Protection products.

There are many Protection Options available and there is an assortment of factors that could impact the performance of the protection chosen. It's important that a qualified person chooses the proper material to sufficiently protect the sling from edges or surfaces.

Wear Protection Features & Benefits:

- Helps to extend the life of a sling by reducing abrasive wear
- Prevents damage to the load surface
- Several Material options available
- Can be easily attached by using hook & loop
- Available in many lengths and widths

MATERIAL TYPES:

ABN

Bulked Nylon



AWB-N / AWB-P

Nylon or Polyester Webbing

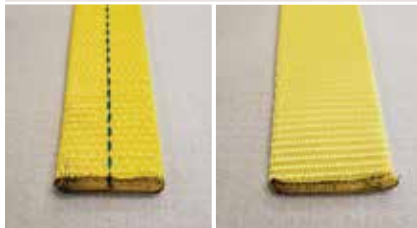

GG

Gator Grip
(Flat Sleeve or Sewn Only)



AFT516

5/16" Felt Pad



ALT

Heavy Leather



APVC

PVC



WEAR PAD TYPES:

HLTS

Hook & Loop
Tubular Sleeve



HLFS

Hook & Loop
Flat Sleeve



TS

Tubular
Sleeve



FS

Sewn Flat
Sleeve



KC

Komodo Cover
(Sewn on)



CUT PROTECTION

Cut Protection Features & Benefits:

- Provides greater resistance to sling cutting
- Prevents damage to the load surface
- Reduces bearing pressure amounts at contact areas
- Several Material options available
- Available in many lengths and widths

MATERIAL TYPES:

ACGH
Caiman Guard
Heavy Duty
5.7mm HMPE



WEAR PAD TYPES:

HLTS
Hook & Loop
Tubular Sleeve



HLFS
Hook & Loop
Flat Sleeve

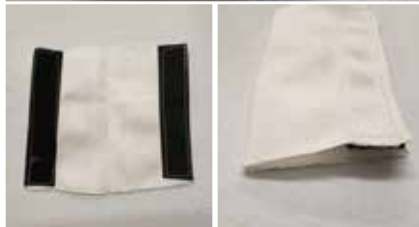

TS
Tubular
Sleeve



FS
Sewn Flat
Sleeve



KC
Komodo Cover
(Sewn on)



ACP
Corner
Protector



PROTECTION



HOOK & LOOP TUBULAR SLEEVE DIMENSIONAL INFORMATION

Bulked Nylon Part #	Webbing Part #	Felt 5/16" .3125 thickness Part #	Sleeve Width (in.) Part #	Big Easy Roundsling		Big Easy Braided Roundsling		Big Easy High Performance Roundsling		Wire Rope Diameter (in.)	Chain Size (Inches)
				Single Leg	Double Leg (EE)	6-Part	8-Part	Single Leg	Double Leg (EE)		
ABN-HLTS-4	AWB-HLTS-4		4							1/4	
ABN-HLTS-5	AWB-HLTS-5		5							5/16 - 1/2	
ABN-HLTS-6	AWB-HLTS-6		6	30 - 60				BHP10		9/16 - 7/8	7/32
ABN-HLTS-8	AWB-HLTS-8		8	90 - 120 - 150	30 - 60			BHP20 - BHP30		1 - 1-1/2	9/32 - 3/8
ABN-HLTS-10	AWB-HLTS-10	AFT516-HLTS-10	10	180 - 240	90 - 120	30 - 60	30	BHP40 - BHP50	BHP10	1-3/4 - 2	1/2 - 5/8
ABN-HLTS-12	AWB-HLTS-12	AFT516-HLTS-12	12	360 - 400	150 - 180	90	60	BHP60 - BHP80	BHP20 - BHP30	2-1/2	3/4
ABN-HLTS-14	AWB-HLTS-14	AFT516-HLTS-14	14	600 - 800	240		90	BHP90 - BHP125	BHP40 - BHP50		7/8 - 1
ABN-HLTS-16	AWB-HLTS-16	AFT516-HLTS-16	16	1000	360 - 400	120 - 150	120	BHP150 - BHP175	BHP60 - BHP80		1-1/4
ABN-HLTS-18	AWB-HLTS-18	AFT516-HLTS-18	18		600	180 - 240	150 - 180	BHP200	BHP90 - BHP100		
ABN-HLTS-20	AWB-HLTS-20	AFT516-HLTS-20	20		800				BHP125		
ABN-HLTS-22	AWB-HLTS-22	AFT516-HLTS-22	22		1000	360	240		BHP150 - BHP175		
ABN-HLTS-24	AWB-HLTS-24	AFT516-HLTS-24	24						BHP200		
ABN-HLTS-26	AWB-HLTS-26	AFT516-HLTS-26	26			600	360				
ABN-HLTS-30	AWB-HLTS-30	AFT516-HLTS-30	30			800	600				
ABN-HLTS-34	AWB-HLTS-34	AFT516-HLTS-34	34			1000	800				

HOOK & LOOP FLAT SLEEVE DIMENSIONAL INFORMATION

Bulked Nylon Part #	Webbing Part #	Felt 5/16" .3125 thickness Part #	Sleeve Width (in.) Part #	Web Sling Width* (1-Ply & 2-Ply)	Big Easy Roundsling		Big Easy Braided Roundsling		Big Easy High Performance Roundsling		Wire Rope Diameter (in.)	Chain Size (Inches)
					Single Leg	Double Leg (EE)	6-Part	8-Part	Single Leg	Double Leg (EE)		
ABN-HLFS-3	AWB-HLFS-3	AFT516-HLFS-3	3	1					BHP10		1/4 - 7/16	
ABN-HLFS-4	AWB-HLFS-4	AFT516-HLFS-4	4	2	30 - 60	30 - 60			BHP20		1/2 - 3/4	7/32 - 9/32
ABN-HLFS-5	AWB-HLFS-5	AFT516-HLFS-5	5	3	90 - 120 - 150	60			BHP30	BHP10	7/8 - 1-1/8	3/8
ABN-HLFS-6	AWB-HLFS-6	AFT516-HLFS-6	6	4	180 - 240	90 - 120	30		BHP40 - B HP80	BHP20	1-1/4 - 1-1/2	1/2
ABN-HLFS-8	AWB-HLFS-8	AFT516-HLFS-8	8	6	360 - 400	150 - 240	60	30	BHP90 - BHP125	BHP30	1-3/4 - 2-1/4	5/8
ABN-HLFS-10	AWB-HLFS-10	AFT516-HLFS-10	10	8	600 - 800	360	90 - 120	60 - 90	BHP150 - BHP175	BHP40 - BHP80	2-1/2	3/4 - 7/8
ABN-HLFS-12	AWB-HLFS-12	AFT516-HLFS-12	12	10	1000	600	150 - 180	120 - 150	BHP200	BHP90 - BHP125		1

* 3-Ply & 4-Ply sling: Use one size larger sleeve

** Width of sleeve may vary some based on the material used. This chart is used for approximate measurement.

SEWN FLAT SLEEVE DIMENSIONAL INFORMATION

Bulked Nylon Part #	Webbing Part #	Felt 5/16" .3125 thickness Part #	Sleeve Width (in.) Part #	Web Sling Width* (1-Ply & 2-Ply)	Big Easy Roundsling		Big Easy Braided Roundsling		Big Easy High Performance Roundsling		Wire Rope Diameter (in.)	Chain Size (Inches)
					Single Leg	Double Leg (EE)	6-Part	8-Part	Single Leg	Double Leg (EE)		
ABN-FS-3	AWB-FS-3	AFT516-FS-3	3	1	30 - 60						1/4 - 3/4	7/32
ABN-FS-4	AWB-FS-4	AFT516-FS-4	4	2	90 - 120 - 150	30 - 60			BHP10		7/8 - 1-1/8	9/32 - 3/8
ABN-FS-5	AWB-FS-5	AFT516-FS-5	5	3	180 - 240	90 - 120	30		BHP20 - BHP30		1-1/4 - 1-1/2	1/2
ABN-FS-6	AWB-FS-6	AFT516-FS-6	6	4	360 - 400	150 - 180	60	30	BHP40 - BHP80	BHP10	1-3/4	5/8
ABN-FS-8	AWB-FS-8	AFT516-FS-8	8	6	600 - 800	240 - 360	90 - 120	60	BHP90 - BHP100	BHP20 - BHP40	2 - 2-1/2	3/4 - 7/8
ABN-FS-10	AWB-FS-10	AFT516-FS-10	10	8	1000	600	150 - 180	90 - 150	BHP125 - BHP175	BHP50 - BHP80		1
ABN-FS-12	AWB-FS-12	AFT516-FS-12	12	10		800 - 1000	240	180	BHP200	BHP90 - BHP125		1-1/4

*For 3-Ply & 4-Ply sling: Use one size larger sleeve

**Width of sleeve may vary some based on the material used. This chart is used for approximate measurement.

WEB LOAD HUGGER - ASSEMBLIES (WLH)



Features & Benefits:

- Soft, Pliable and non-abrasive polyester webbing
- Lighter and easier to handle than chain load binders
- More durable and stronger than elastic tension bands
- 1", 2", 3" & 4" widths available
- Standard Lengths in Stock. Special Material options available upon request
 - » Custom lengths available and fabricated upon request
- Corner Protectors and sleeves also available

WEB LOAD HUGGER - ASSEMBLIES

Part #	Width (in.)	Overall Length (ft.)**	Fixed End Length (in.)	End Fittings	Rated Capacity (lbs.)*
WLH1X20VSH	1"	20'	18"	Vinyl Coated S-Hook	800
WLH1X20WH	1"	20'	18"	Wire Hooks	800
WLH2X27WH	2"	27'	18"	Wire Hooks	3,333
WLH2X30WH	2"	30'	18"	Wire Hooks	3,333
WLH2X27FH	2"	27'	18"	Flat Hooks	3,333
WLH2X30FH	2"	30'	18"	Flat Hooks	3,333
WLH2X27CA	2"	27'	18"	Chain Anchor	3,333
WLH2X30CA	2"	30'	18"	Chain Anchor	3,333
WLH3X27WH	3"	27'	18"	Wire Hooks	5,400
WLH3X30WH	3"	30'	18"	Wire Hooks	5,400
WLH3X27FH	3"	27'	18"	Flat Hooks	5,000
WLH3X30FH	3"	30'	18"	Flat Hooks	5,000
WLH3X27CA	3"	27'	18"	Chain Anchor	5,000
WLH3X30CA	3"	30'	18"	Chain Anchor	5,000
WLH4X27WH	4"	27'	18"	Wire Hooks	6,666
WLH4X30WH	4"	30'	18"	Wire Hooks	6,666
WLH4X27FH	4"	27'	18"	Flat Hooks	5,400
WLH4X30FH	4"	30'	18"	Flat Hooks	5,400
WLH4X27CA	4"	27'	18"	Chain Anchor	5,400
WLH4X30CA	4"	30'	18"	Chain Anchor	5,400

*Rated Capacity based on 3:1 Design Factor

**Standard Lengths provided in chart. Custom lengths available upon request

WEB LOAD HUGGER - ENDLESS

Part #	Width (in.)	Rated Capacity (lbs.)
WLH1X__EN	1"	800
WLH2X__EN	2"	3,333
WLH3X__EN	3"	5,000
WLH4X__EN	4"	5,400

*PROVIDE TOTAL WEB LENGTH AFTER "X" WHEN ORDERING

TIE DOWN STRAPS (TDS) & END FITTING OPTIONS

Features & Benefits:

- Soft, Pliable and non-abrasive polyester webbing
- 1", 2", 3" & 4" widths available
- Standard Lengths in Stock. Special Material options available upon request
 - » Custom lengths available and fabricated upon request
- Corner Protectors and sleeves also available

TIE DOWN STRAP				
Part #	Width (in.)	Length (ft.)	End Fittings	Rated Capacity (lbs.)*
TDS1X20SH	1"	20'	Vinyl Coated S-Hook	800
TDS1X20WH	1"	20'	Wire Hooks	800
TDS2X27WH	2"	27'	Wire Hooks	3,333
TDS2X30WH	2"	30'	Wire Hooks	3,333
TDS2X27FH	2"	27'	Flat Hooks	3,333
TDS2X30FH	2"	30'	Flat Hooks	3,333
TDS3X27CA	2"	27'	Chain Anchor	3,333
TDS2X30CA	2"	30'	Chain Anchor	3,333
TDS3X27WH	3"	27'	Wire Hooks	5,400
TDS3X30WH	3"	30'	Wire Hooks	5,400
TDS3X27FH	3"	27'	Flat Hooks	5,000
TDS3X30FH	3"	30'	Flat Hooks	5,000
TDS3X27CA	3"	27'	Chain Anchor	5,000
TDS3X30CA	3"	30'	Chain Anchor	5,000
TDS4X27WH	4"	27'	Wire Hooks	6,666
TDS4X30WH	4"	30'	Wire Hooks	6,666
TDS4X27FH	4"	27'	Flat Hooks	5,400
TDS4X30FH	4"	30'	Flat Hooks	5,400
TDS4X27CA	4"	27'	Chain Anchor	5,400
TDS4X30CA	4"	30'	Chain Anchor	5,400

END FITTINGS					
Part #	End Fittings	Webbing Width (in.)	Rated Capacity (lbs.)	Webbing Width (in.)	Rated Capacity (lbs.)
SH	Vinyl Coated S-Hook	1"	800		
WH	Wire Hook	1"	800	3"	5,400
FH	Flat Hook	1"	800	3"	5,000
SK	Snap Hook	1"	800	3"	5,000
TSK	Twisted Snap Hook	1"	800	3"	5,000
DR	D-Ring	1"	800	3"	5,000
ET	E-Track	1"	800	3"	5,000
EN	Endless	1"	800	3"	5,000
CA	Chain Anchor	1"	800	3"	5,000
WH	Wire Hook	2"	3,333	4"	6,666
FH	Flat Hook	2"	3,333	4"	5,400
SK	Snap Hook	2"	3,333	4"	5,400
TSK	Twisted Snap Hook	2"	3,333	4"	5,400
DR	D-Ring	2"	3,333	4"	5,400
ET	E-Track	2"	3,333	4"	5,400
EN	Endless	2"	3,333	4"	5,400
CA	Chain Anchor	2"	3,333	4"	5,400



Flat Hook

Wire Hook

Flat Snap Hook

Twisted Snap Hook

Cluster Hook

Forged D-Ring

Stamped D-Ring

Chain Extension w/ Pear Link & Grab Hook

CamBuckle

WEB CARGO NET



Web Cargo Nets are considerably more flexible, light-weight and compact than wire or rope nets.

Features & Benefits:

- Made of durable 1-3/4" nylon webbing with an anti-static finish.
- Nets have a 6.25" mesh opening
- Nets are rated at 4,500 lbs. and based on a 5:1 design factor. Commercial nets are available with either 5/8" galvanized pear shaped links or 1" polypropylene rope becket (as seen above) in each corner.

Custom Net Sizes and Material Options are available upon request.

Size	1" Polypropylene Rope Becket Corners	5/8" Galvanized Pear Shaped Link Corners	Mesh Opening	Weight (lbs.)	Rated Capacity (lbs.)
4x4	NWCNR4	NWCNL4	6.25"	11	4500
6x6	NWCNR6	NWCNL6	6.25"	17	4500
8x8	NWCNR8	NWCNL8	6.25"	22	4500
10x10	NWCNR10	NWCNL10	6.25"	30	4500
12x12	NWCNR12	NWCNL12	6.25"	40	4500
14x14	NWCNR14	NWCNL14	6.25"	48	4500
16x16	NWCNR16	NWCNL16	6.25"	57	4500
18x18	NWCNR18	NWCNL18	6.25"	73	4500
20x20	NWCNR20	NWCNL20	6.25"	87	4500

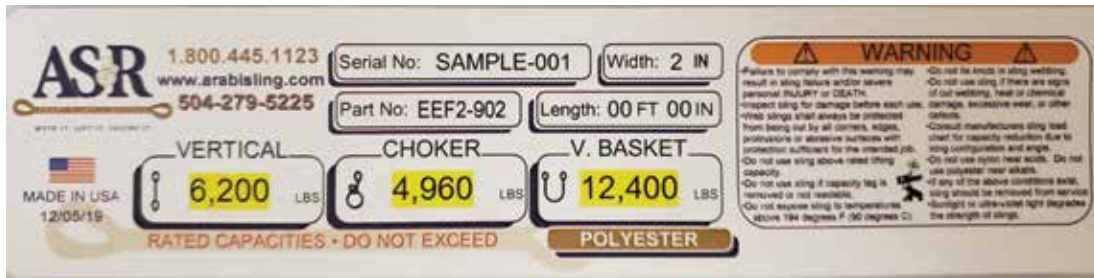

- This is the Standard Tag offered on all slings. These tags are UV Resistant and offer Full Color Private Labeling. They are proven in the field and hold up extremely well in the harshest of environments.



- Cost Effective Heavy Duty PVC tag that is designed for unforgiving environments.
- Orange Material color with black print is standard and Private Labeling is available.

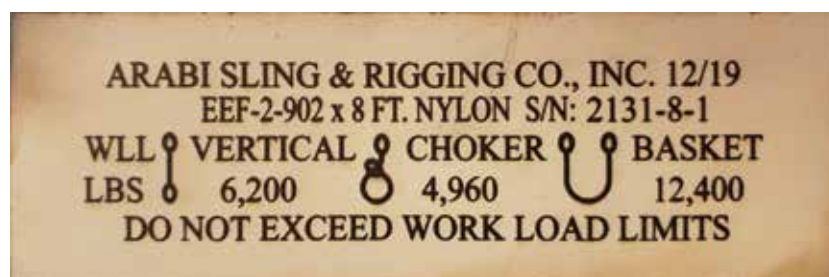

- Heavy Duty Leather Tag with Laser Engraved text. These tags are still very popular options in certain areas and industries. They can be Private Labeled but there are limitations with this tag.

Call Our Sales Team for More Information on These Tags and Other Options Available.

MARINE BOAT SLING

RATED CAPACITY IN POUNDS			
	Part #	Basket Hitch @ 90°	Width
ONE PLY	BLS1902	6,400	2"
	BLS1903	7,200	3"
	BLS1904	12,800	4"
	BLS1906	19,200	6"
	BLS1908	25,600	8"
	BLS1910	32,000	10"
	BLS1912	38,400	12"
TWO PLY	BLS2902	12,800	2"
	BLS2903	17,800	3"
	BLS2904	23,000	4"
	BLS2906	32,600	6"
	BLS2908	41,000	8"
	BLS2910	48,000	10"
	BLS2912	60,000	12"



Boat Lifting or Marine Lifting Slings are designed to help you conveniently lift any boat. Choose from Single or Double Ply slings with Widths up to 12". Lift up to 53 tons when pairing slings and rigging in a Basket Hitch.

Features & Benefits:

- Webbing widths from 2" to 12"
- Rated Capacities from 6,400 lbs. to 53,700 lbs.
- Rig additional pairs or individual slings to increase capabilities
- Custom designs are available upon request
- Non-abrasive material helps protect the boat's hull and finish
- Lightweight for ease in handling
- Excellent resistance to rot, mildew, oil and seawater.
 - » Fibers do not support bacterial or fungal growth, or is adversely affected by water immersion

Fittings & Accessories

- Reusable Alloy Steel Triangle
- Loose Pin Hardware
- Lead Weights
- Sliding Chine and Keel Pads
- Edge Guard Wear Pads
- Extra Sewn Eyes (Single Ply Capacity Only)
- Disconnect – allows the sling to be removed from beneath the boat without removing sling eye from hook. (Protective Flap Standard)



WARNING: Do not exceed rated capacities. Sling capacity decreases as the angle from horizontal decreases. Slings should never be used at angles less than 30 degrees.

MARINE BOAT SLING ORDERING GUIDE

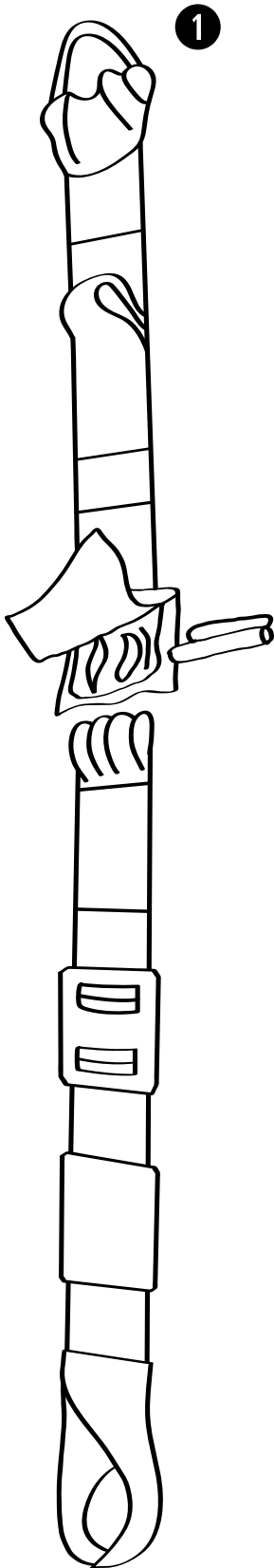

MATERIAL	NYLON / POLYESTER	Circle One
EDGE GUARD	YES / NO	Circle One
# OF PLYS	_____	(2-ply Standard)
SLING WIDTH (in.)	_____	
EYE WIDTH (in.)	_____	
EYE TYPE	FLAT EYE / TAPERED	Circle One
IF TAPERED, NOTE WIDTH	_____	
A OVERALL SLING LENGTH	_____	Bearing to Bearing
2-PIECE QUICK DISCONNECT:	YES / NO	Circle One
IF 2-PIECE, INCLUDE DISCONNECT PIN	YES / NO	Circle One
B LONG LENGTH (ft.)	_____	Bearing to Bearing
# OF FINGERS	_____	
C SHORT LENGTH (ft.)	_____	Bearing to Bearing
# OF FINGERS	_____	
PIN	YES / NO	Circle One
D WEIGHTED KEEL PAD	YES / NO	Circle One
SLIDING	_____ ft.	
SEWN-ON	_____ ft.	
Starting	_____ ft.	from 1 or 2
E EXTRA EYES	YES / NO	Circle One
EYE 1 - PLACEMENT	_____ ft.	Measured from 1 or 2 (Bearing to Bearing)
EYE 2 - PLACEMENT	_____ ft.	Measured from 1 or 2 (Bearing to Bearing)
EYE 3 - PLACEMENT	_____ ft.	Measured from 1 or 2 (Bearing to Bearing)
F CHINE PAD	YES / NO	Circle One
SLIDING	_____ ft.	
SEWN-ON	_____ ft.	
Starting	_____ ft.	from 1 or 2
G LOOSE PIN SHACKLE	YES / NO	Circle One
QUANTITY	_____	

YANNI I PILOT LADDER

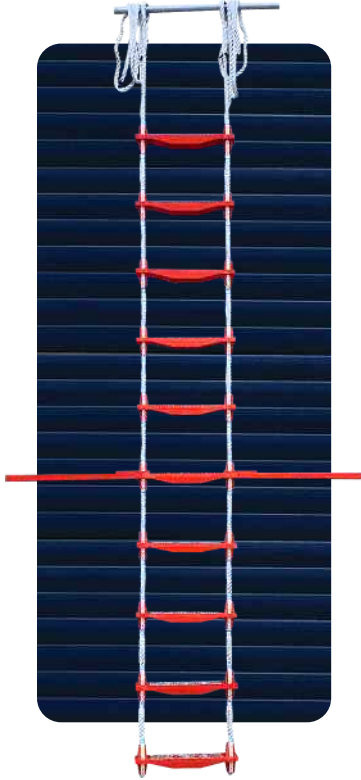

- **USCG Approval Number:** 163.003/20/0
- **Meets and exceeds Solas standards**
- **Rope:** 3/4" Synflex Poly-Plus, with orange core.
- **Clamps:** Aluminum
- **Steps and spreaders:** Molded polyurethane, orange in color, with diamond shaped grooves and non-skid grit surface. Four integrated plastic hearts per step to prevent steps from rolling.
- **Length:** Up to 70' in length, made to order.
- **Replacement steps available if needed.**

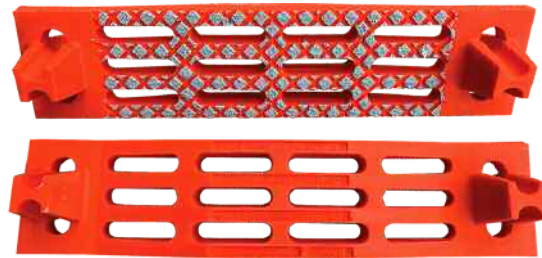

YANNI II PILOT LADDER

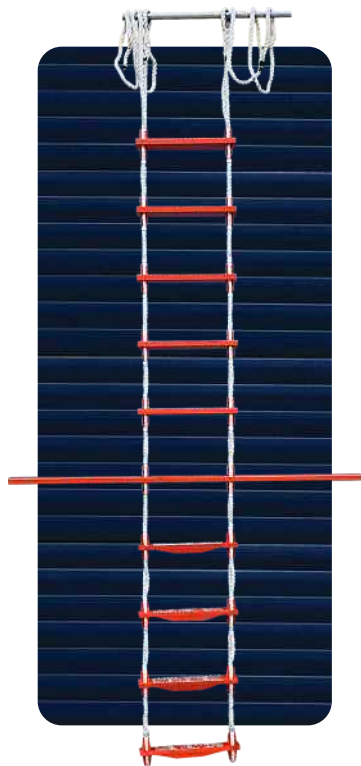

- **USCG Approval Number:** 163.003/21/0
- **Meets and exceeds Solas standards**
- **Rope:** 3/4" Synflex Poly-Plus, with orange core.
- **Clamps:** Aluminum
- **Steps and spreaders:** Oak wood, diamond shaped grooves, non-skid grit surface and painted international orange. Bottom four steps are molded polyurethane with diamond shaped grooves and non-skid grit surface.
- **Length:** Up to 70' in length, made to order.
- **Replacement steps available if needed.**



YANNI I EMBARKATION LADDER

- **USCG Approval Number:** 160.117/9/0
- **Meets and exceeds Solas standards**
- **Rope:** 3/4" Synflex Poly-Plus, with orange core.
- **Clamps:** Aluminum
- **Steps and spreaders:** Molded polyurethane, orange in color, with diamond shaped grooves and non-skid grit surface. Four integrated plastic hearts per step to prevent steps from rolling.
- **Length:** Up to 70' in length, made to order.
- **Replacement steps available if needed.**



YANNI II EMBARKATION LADDER

- **USCG Approval Number:** 160.117/8/0
- **Meets and exceeds Solas standards**
- **Rope:** 3/4" Synflex Poly-Plus, with orange core.
- **Clamps:** Aluminum
- **Steps:** Oak wood, diamond shaped grooves, non-skid grit surface and painted International Orange.
- **Length:** Up to 70' in length, made to order.
- **Replacement steps available if needed.**

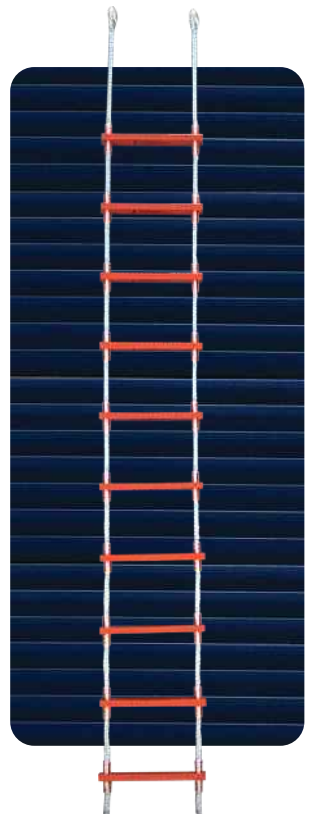

ATLAS I PILOT LADDER

ABS PDA #20-2009573-1-PDA
ISO 799-1

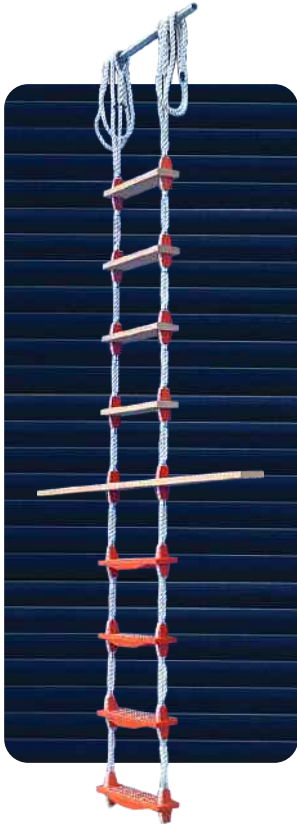

- Rope suspension members 3/4" poly plus, white with orange core.
- Steps and spreaders are oak wood, unfinished, with diamond groove pattern. Four polycarbonate hearts per step and spreader to prevent steps from rolling. Bottom four steps are orange polyurethane.
- Aluminum duplex sleeves swaged to secure steps in place.
- Galv. rope thimble for securing ladder to structure. 3/4" galv. bolt type anchor shackle available. Optional 1" x 10' poly plus rope to secure ladder and adjust height when installed.



ATLAS II PILOT LADDER

ABS PDA #20-2011124-PDA
ISO 5489



- Rope suspension members 3/4" poly plus, White with orange core.
- Steps are oak wood, unfinished, with diamond groove pattern. Four polycarbonate hearts per step to prevent steps from rolling.
- Aluminum duplex sleeves swaged to secure steps in place.
- Galv. rope thimble for securing ladder to structure. 3/4" galv. bolt type anchor shackle available. Optional 1" x 10' poly plus rope to secure ladder and adjust height when installed.



**WIRE ROPE • WIRE ROPE SLINGS • CHAIN
CHAIN SLINGS • SHACKLES • HOOKS • HOISTS
TESTING/PROOF LOADING: CHANT TEST BED WITH 600K LBS. CAPACITY**



Domestic & Import Available



WARRANTY

Any warranty, expressed or implied as to quality, performance or fitness for use is always premised on the condition that the published rated capacities apply only to new, unused slings and assemblies, that the mechanical equipment on which such products are used is properly designed and maintained, that such products are properly stored, handled, used and maintained, and properly inspected on a regular basis during the period of use.

Seller shall not be liable under any circumstances for consequential or incidental damages or secondary charges including but not limited to personal injury, labor costs, a loss of profits resulting from the use of said products or from said products being incorporated in or becoming a component of any other product.

4700 East Judge Perez, Meraux, LA 70075
(504) 279-5225 | (800) 445-1123

sales@arabising.com
www.arabising.com

