

ACCORDING TO FEDERAL SPECIFICATION RR-C-271D, TYPE IV A, CLASS 2, GRADE A, AMENDMENT 1. HOT GALVANIZED, FORGED CARBON STEEL, HEAT TREATED, WITH ALLOY PINS. PERMANENTLY MARKED WITH SIZE AND WORKING LOAD LIMIT.

AVAILABLE IN DOMESTIC AND IMPORT.

OTHER STYLES AVAILABLE:
 BOLT TYPE ANCHOR
 ROUND PIN
 CHAIN STYLE

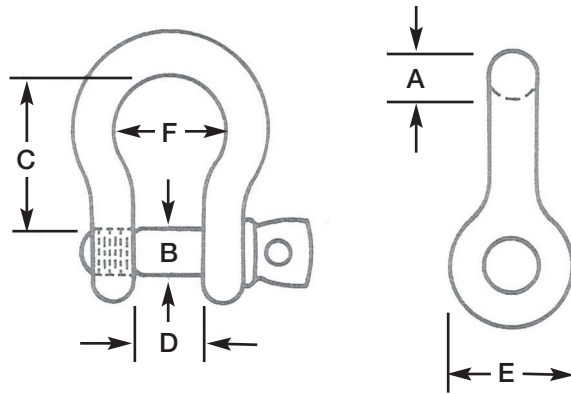

CAUTION: NEVER EXCEED THE WORKING LOAD LIMIT.

Do not use screw pin shackles if the pin can roll under load and unscrew.

SIZE (A)	WORKING LOAD LIMIT IN TONS	PIN DIAM. IN INCHES (B)	APPROX. WEIGHT EACH IN POUNDS	DIMENSIONS IN INCHES			
				C	D	E	F
3/16"	1/3	1/4	.05	.88	.38	.56	.63
1/4"	1/2	5/16	.13	1.06	.47	.66	.75
5/16"	3/4	3/8	.21	1.25	.53	.81	.84
3/8"	1	7/16	.33	1.44	.63	.97	1.00
7/16"	1.1/2	1/2	.47	1.69	.75	1.06	1.13
1/2"	2	5/8	.76	1.88	.81	1.31	1.25
5/8"	3.1/4	3/4	1.44	2.44	1.06	1.56	1.69
3/4"	4.3/4	7/8	2.3	2.88	1.19	1.88	1.94
7/8"	6.1/2	1	3.5	3.38	1.44	2.13	2.19
1"	8.1/2	1.1/8	5.0	3.81	1.69	2.38	2.63
1-1/8"	9.1/2	1.1/4	7.0	4.25	1.75	2.63	2.88
1-1/4"	12	1.3/8	9.5	4.69	2.00	3.00	3.13
1-3/8"	13.1/2	1.1/2	13.0	5.31	2.13	3.25	3.50
1-1/2"	17	1.5/8	16.5	5.69	2.31	2.50	3.75
1-3/4"	25	2	29.0	7.06	2.88	4.25	4.88
2"	35	2.1/4	43.0	7.75	3.31	4.88	5.44
2-1/4"	45	2.1/2	59.4	9.25	3.63	5.25	5.50
2-1/2"	55	2.3/4	86.0	10.75	4.13	5.88	7.25
3"	85	3.1/4	119.5	13.75	4.88	6.75	7.63

F.O.B. WAREHOUSE